

# PORTHLEVEN MUSEUM

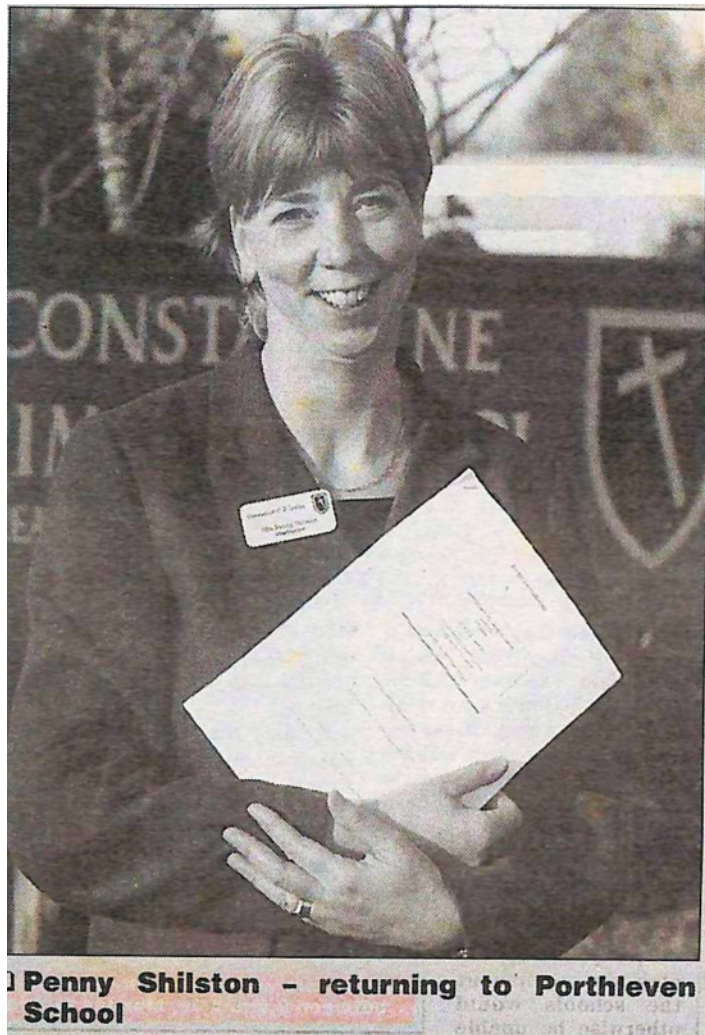
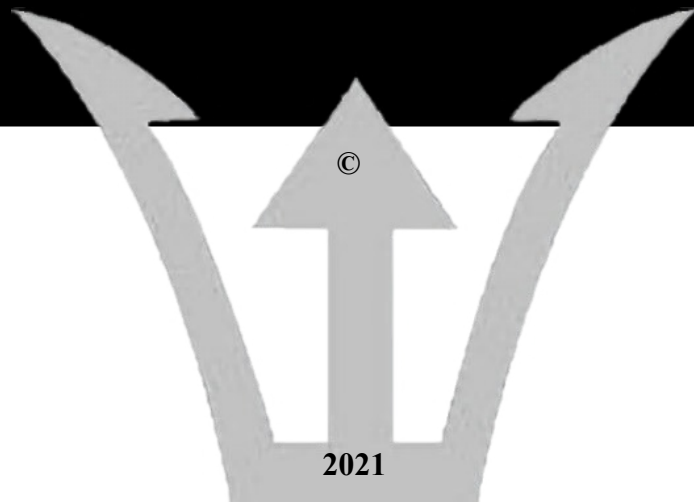

Penny Shilston - returning to Porthleven School

## PAT ADAMS SCRAP BOOK SERIES

### BOOK 16

FEBRUARY 2000 TO SEPTEMBER 2000

Category	Scrap Books	PLVCM2022.5.1
Category	Collection	PLVCM2022.7.1

# Councillors should resign

From, Mr T Osborne, Chairman Porthleven Harbour and Dock Company, Berners Mews, London W1P 3LF.

The Packet recently reported the proceedings - hardly a debate - of a Porthleven town council meeting at which new councillor, John Strike, led the savage criticism and attack on the distinguished service of Godfrey Stephens and Roy Bradbury, our councillors at Kerrier district council.

Readers will recall that Roy Bradbury resigned because he could no longer tolerate the irrational utterances of fellow councillors, many of whom have little to contribute except criticism. His resignation created a vacancy on the council allowing John Strike to become a councillor without being democratically elected.

Godfrey Stephens has represented the community, both at town and district level, for many years and many of the improvements that we have seen over the years have been due, in some measure, to the efforts of

Godfrey Stephens and Roy Bradbury. Mr Strike, who now lives outside the village though has a business there, is reported to have criticised the performance of our district councillors by citing their support for the steps to my daughter's restaurant.

It seems to me that the public-spirited service of these old school councillors stands in stark contrast to any real record of achievement on the part of those who criticise.

Whilst there remain a few town councillors of integrity such as Jim Stokes, a former chairman, the council is woefully short of talent and integrity. Indeed it is interesting that Mr Strike has so influenced the other councillors in these criticisms that the community now faces the prospect of losing the valuable services of another experienced member because of the intolerance of recently-created councillors.

Perhaps the decent thing for councillors to do is to resign en masse, offering itself for re-election in the hope that Porthleven might possibly get a council which would be more attuned to the service of its ratepayers.

See report page one

# Why was garden proposal changed?

From, A Zeimann, Bay View, Porthleven.

The proposed "blot on the landscape" for Frankies Allotments is still very much on many people's lips and not only Porthleven's residents, but those people who like to come to our village because of its unspoilt character.

I see that Mr Andrew Bell has been expounding on the subject (*Helston Packet*, January 6). Obviously the intemperate and bitter comments he makes do the organisation he represents nothing but harm, and adds nothing to reasonable discussion.

According to Mr Bell, the views of individuals who are critical of a proposal are of no value because these individuals are not representative of specific groups. As many of those who have written to Kerrier district council objecting to the

scheme live on Breageside they are no doubt very pleased to be classed as vociferous agitators who lack constructive argument!

Mr Bell goes on to say that if the scheme now proposed is rejected the owner would have the perfect excuse to develop the site for at least three houses. What rubbish - this is yet another threat to discourage constructive discussion.

I do not know anyone who is against the principle of the garden. What we would wish is for the proposal, which was agreed over three years ago at the public meeting of Porthleven Millennium Trust, to be implemented. Copies of this proposal (not written by me) are available to anyone who is interested. Why was it changed without public consultation?

I see that Porthleven town council has

resubmitted the plans for the garden but it is understood they show very little change and that the main item of contention, the steps to the Ship Inn, are still included.

Councillors have given me the distinct impression of being pressurised to support the proposal because of threats of grant money being withdrawn if they did not and the likelihood that further grant money for the village would be jeopardised.

When questioned regarding the lease, maintenance, locking of gates etc, no costs are known, with no provision in this year's budget. What a sorry state of affairs!

In view of these comments, I fail to see how Mrs Elsie Balme, town clerk, can say the council is happy with its decision.

# 'No' to improvements at any cost

From Arthur Roberts, Chairman Porthleven Fishermen and Boatowners' Association.

May I put the record straight regarding Trevor Osborne's comments in the *Helston Packet* of February 5.

Mr Osborne knows that our representatives on the Harbour Management Committee resigned because there was no real consultation. It became blatantly obvious to our association that we were invited onto that committee to "rubber stamp" his plans.

Our association has represented the fishing and boating community of this village for at least 70 years. All boatowners, and those who have an interest in the harbour, have the opportunity to join the association and we welcome new members. We have not considered it necessary to reveal the names of our members to the Harbour and Dock Company for very good reason.

Mr Osborne knows full well that we have put our alternative suggestions to the Harbour and Dock Company. This was done at a public meeting on June 26 at the Porthleven School. This meeting was convened by the harbourmaster and addressed by Mr C George of Hyder Consultants. Since that time we have also met with representatives of the Harbour and Dock Company and officials from The Ministry of Agriculture Food and Fisheries. Following the advice of MAFF we have written to Mr Osborne to inform him once again of these proposals.

I have no intention of circulating any rumours regarding any circumstance whatsoever. I seek to live my life by the truth and have every intention of continuing to do so. From the inaugural meeting of the millennium committee, I made it clear that my desire for Porthleven was to protect and pass on the privileges and inheritance that I have so richly enjoyed. An inheritance that has been handed down through many generations.

As a native of Porthleven I would be delighted to see a garden in the village that both residents and visitors can enjoy. I wish the Millennium Trust and

all those involved with the project every success.

Following the disbanding of the Harbour Management Committee, Mr Osborne wrote to all those who had been on the committee saying: "The fishermen had thwarted his plans." This was written in a letter that could have been forwarded to the Press. I would point out that it came just two days after Mr Osborne had said he would report that the committee had been disbanded amicably.

We are still prepared to enter into profitable consultation with Mr Osborne but wonder whether he will be prepared to listen to our concerns.

There were over 100 villagers present at the meeting in June and all accepted that our alternative plan should meet the needs of Mr Tommy

Nielsen and the local harbour users. It was also evident from the meeting in the Public Hall that there was no support for the current plans for the harbour.

Mr Osborne has said on many occasions that it has to be "what the people of Porthleven want." The message from the people of Porthleven is "We don't want it."

Porthleven has been described as "The Jewel in the Ring." When landing my fish on the quayside I often get into conversation with visitors. When talking about the harbour and its surroundings it always prompts the same response "Don't let them spoil it."

As an association we are all in favour of improvements to our village but I would stress: "Improvements are acceptable, but not improvements at any cost."

FEBRUARY 2000

## Porthleven council news

A MEETING with youngsters would be the first step towards getting skateboarding facilities in Porthleven, the council has been told.

The advice came from a representative of Cornwall Rural Community Council, who said money, possibly amounting to several thousand pounds, was available for such projects.

Details of what facilities the youngsters wanted and how much money could be sourced locally would need to be passed to the CRCC, which might be able to assist with the project.

Councillors asked clerk Elsie Balme to pursue the matter as soon as possible so that a meeting could be arranged.

Quotes are to be obtained for new infant swings at the recreation ground.

Mrs Balme said the existing swings were in a poor state of repair and unlikely to pass the annual safety check, which is due next month.

Replacement swings are to be funded from the council's Gala Parc bank account.

Young people in Porthleven are to be warned that a "teenage village" structure shortly to be installed on the recreation ground will be removed if they vandalise it.

Charles Budd said it was for the young people and he hoped they would look after it, but a sign should be put up warning them of the consequences if they didn't.

The council is to ask David Taylor, who Mr Budd described as a "first-class workman", to submit an estimate for installing the structure.

The council has ordered a copy of *Getting Greens Registered* - a guide to law and procedure concerning town and village greens.

Information about the book has come from the Open Spaces Society, which the council recently joined in the hope of gaining advice on how to protect parts of the village including the Harbour Head.

## Ban's quest for new HQ continues

PORTHLEVEN Town Band is to continue its quest for new premises after one option was likely to be ruled out because it would mean sharing a new building with other community groups.

Currently based in Salt Cellar Hill, the 100-year-old band is keen to find alternative accommodation as part of a drive to attract and retain new players.

Following a failed attempt to bid for the former Sunday School in Fore Street, committee members identified the disused tennis courts on Porthleven's recreation ground as a possible site for a new building.

The land is a registered charity, of which town councillors are the trustees, and the band had asked the council to consider making it available to them.

Following some disagreement as to whether that would be possible under the terms of the

charity, band secretary Peter Boyd and town clerk Elsie Balme both sought clarification.

At a council meeting last week, Mr Boyd said there would be no problem with erecting a building on the land, but the council would not be able to allow the band exclusive access.

Members of the band committee are to discuss the situation next month, but Mr Boyd said he did not think a shared building would be an acceptable solution.

"I can't prejudge what the band will decide, but I don't think they would wish to partake in a shared building," he said. "The band has a benefactor in the village, who requires to remain nameless, and I am pretty confident they would not fund a shared building. Other potential funding bodies, such as the Arts Council, would also be very reluctant."

Councillors were keen to stress their support for the band, among them John Strike,

who said it was a great asset to the village.

Gill Menhennet, who described the band as an integral part of the community, suggested it could build on land currently used as an amenity area.

County Councillor David Richards said joining the band gave youngsters in Porthleven "something worthwhile" to do and made them more public spirited and the council should support whatever decision the band made.

The hunt for new premises has arisen because the current band room lacks basic facilities such as toilets and heating, which also makes it difficult to take advantage of any lottery funding available.

Mr Boyd said the band was "extremely grateful" for the long-standing support of the Porthleven Harbour and Dock Company, which for the past 80 years had allowed the band exclusive use of its premises, practically free of charge.



Demelza Christophers is presented with her cup by Mike Watkins



Michelle Stringer receives her cup from Clive Christophers

FEBRUARY



Tom Kennedy receives his trophy from Paul Bates (left) and Mike Watkins (right)

# Town band blows its own trumpet

THE achievements of members of Porthleven Town Band were celebrated at an annual presentation evening on Saturday.

A gathering at the football club saw the top accolade - bandsman of the year - awarded to Tom Kennedy.

Bandmaster Mike Watkins said Tom, who during the year had moved from baritone to E flat bass, had proved "beyond doubt" that he had the measure of the larger instrument.

The cup for the most improved junior went to Michelle Stringer, whose sister Louise won the same award last year.

Two talented youngsters shared the cup for the most improved junior player in the senior band.

Cornet players Demelza Christophers and Jason Williams won the coveted award, although Jason was unable to attend the presentation evening.

Clive Christophers, who has stepped down as junior bandmaster, was given a special mention by band chairman Paul Bates.

Mr Bates said Mr Christophers' hard work with the juniors in previous years had given the band a promising future.

Musical director Tony Richards, who usually presents the awards, was unable to attend because of flu.

## Apple trees planted in memory of popular headmaster

TWO apple trees were planted at Porthleven School on Saturday in memory of former head teacher Horace Griffin.

Three generations of Mr Griffin's family, former friends and school representatives were welcomed to the planting ceremony by Porthleven's acting head teacher Paul Hunkin.

Among those attending were Olive Hall, Alfred Pascoe, David Richards, Michael Gale and Vic Strike, all old friends of Mr Griffin, school governors Joan Hughes and Anne Smith and town council chairman Katherine Williams.

Head teacher at Porthleven from 1937 to 1952, Mr Griffin was held in high regard by staff and pupils alike.

In addition to a teaching career spanning almost 40 years, he was well known in the local community as a faithful servant of Cornish Methodism.

A local preacher for 50 years, he was choir master at Fore Street Methodist Church, circuit steward for 13 years and treasurer of the Cornwall Methodist District Overseas Mission.

He was also active in other organisations, including the Special Constabulary - for which he was awarded a long service medal - and was responsible for organising the popular carolare during Gala Week.

His great love and knowledge of plants was reflected in the flower and produce show held each year at the school.



MARCH

Great grandchildren Thomas, Matthew and Peter Griffin with Rachel and Tony Hudson and John and Maude and Opie Griffin plant a tree in memory of the former head teacher at Porthleven, Horace Griffin

Saturday's planting ceremony was organised by Mrs Hughes, who said a \$25 donation to the school from the Griffin family would be spent on books about the environment.

Current pupil Jodie Bidgood has volunteered to look after the trees planted in memory of Mr Griffin.



□ Interviews by Radio Cornwall reporter Tiffany Truscott in the workshop of Creations in Porthleven - left to right: Dawn Boyd, Jane Shainberg (owner) and Tiffany

Picture by Jill Walker

## Radio reporter visits Porthleven craft shop

RADIO presenter Tiffany Truscott paid a visit to the craft shop Creations in Fore Street, Porthleven, to find out about the craft courses that were being run in the workshop there.

Tiffany interviewed the owner, Jane Shainberg, and two of the course tutors for the Radio Cornwall programme broadcast this week. Jane was keen to start new courses to match interest in the area and then to make sure there was a supply of equipment and materials to suit the courses. She felt that any new interest would be good for Porthleven and the surrounding area.

Mrs Jenny Ingam, the sugar craft tutor who has been in catering for 30 years, was asked if the exquisite creations she had brought with her could possibly be made by ordinary folk. She replied that the atmosphere in the courses was friendly and relaxed and pupils were

amazed and delighted at the flowers and fruit they made out of sugar. The results looked impressive but were quite easy to make.

Mrs Dawn Boyd, who teaches how to make unusual cards, said that anyone could be creative and they could learn from each other's ideas. Materials were gleaned from about the home as well as professional craft materials and a hand-made card was so much more personal than a bought one.

Mrs Shainberg felt that the art classes were also a huge success as they were now fully subscribed, and even those who had never felt they had any creative streak were prompted to have a go at dabbling in art. Classes are also held in parchment craft for beginners and improvers.

This month there will be a demonstration of Chinese brush painting. Anyone who is interested in finding out about the art and craft courses should ring Creations on 01326 565652.

## News from Porthleven town council meeting

### Crime reduced

CRIME figures for Porthleven over the past month have once again shown an improvement on the same period last year.

PC Jerry Campion told town councillors there had been 30 calls to the police, six crimes recorded and four people arrested, compared with 44 calls, seven crimes and one arrest the previous year.

The six crimes included three assaults, which were all connected, one possession of drugs, the theft of a mountain bike and a burglary in Fore Street.

### New flag

The council is to fund the cost of a new flag for the Porthleven Brownie pack.

The group's old flag was damaged during the Remembrance Day parade in 1998, and a replacement will cost £75.

Members agreed to donate that sum to the group, which was set up around 25 years ago and is currently thriving.

### Advice needed

The council is to seek advice from CAPTC - the Cornwall Association of Parish and Town

Councils - about setting up a trust that could seek grant funding in connection with the strategy document planned for Porthleven.

The council, which has been working on the document for several months, has been advised the application for grant funding should be made by an outside organisation, rather than the council itself.

David Blanning said one option would be to set up a trust, which would be able to receive grants, with councillors as trustees.

Town clerk, Elsie Balme, said setting up a trust was a complicated business, and if CAPTC could not give advice the services of a lawyer would have to be engaged.

### Lights cash

The council is to renew a loan of £1,000 to the group responsible for Christmas lights in Porthleven.

Charles Budd said the money originally came from the former Gala Week fund, which was for the benefit of the village, as were the lights.

Members agreed the money should be made available to the group, which had also incurred considerable expense last year in putting on a "fantastic" fireworks display on New Year's Eve.

MARCH

## Porthleven town council news

**EXTRA public seats proposed for Porthleven should be in place in time for the summer, a town councillor said last week.**

Gill Menhennet said there were a number of areas in the port where seats were needed, and there was no point installing them after the season had ended.

Town clerk Elsie Balme said she was awaiting authorisation from Kerrier Homes for a hardstanding for seats planned for Gibson Way and Wheal Rose.

Seats donated by the WI and St Bartholomew's Church to mark the new millennium were to be installed on Breageside, she added.

Mrs Menhennet said there was a lack of places to sit on Loe Bar Road, and seats could also be provided for the pier, as long as they were removed during the winter months.

● The council has deferred consideration of quotations for new infant swings in the recreation ground until its next meeting.

Members decided to visit an open day held in Redruth to display play equipment made by young offenders before accepting one of the quotations submitted.

MAJOR work needed to repair a harbourside wall in Porthleven could become part of a wider regeneration scheme because of complications over who owns the land.

The question of who should take responsibility for maintaining the Bay View wall was raised at a town council meeting.

Clerk Elsie Balme said she had seen deeds to one of the Bay View houses which clearly showed the householders did not own the section of path or wall adjoining their property.

However, under the terms of the lease, they were the leaseholders of the land until 2002,

## Wall repair poses question

when the lease expired and ownership of at least part of the wall reverted to the Porthleven Harbour and Dock Company.

The town council had previously carried out minor work to improve the appearance of the wall, but that was not an on-going solution to the problem.

"We don't want to create a situation where it's deemed our responsibility, because it is not," said Mrs Balme.

She suggested Kerrier district council could take on some of the work, but district councillor Roy Bradbury said the authority had refused in the past, and would probably do so again, to take responsibility for what would be a "very costly" exercise.

It was agreed the project could be considered as part of a wider regeneration scheme, possibly one that would attract Objective One funding.

MARCH 2000

## Porthleven

### Age Concern

Members were treated to a delightful programme of music by some of the pupils of Porthleven CP School under the leadership of Mr Brolly and accompanied by their instrumentalists. Each child received a little chocolate gift from a Lucky Dip bag before returning to school.

### Leprosy Mission

Mrs Andrews extended a warm welcome to the Rev Woosley, the area representative for the mission, when he paid his annual visit to the Porthleven Methodist church Ladies Fellowship, and collected donations and used postage stamps. Mr Woosley also showed an interesting selection of coloured slides on the work of the mission. Refreshments were served at the close.

### Women's Institute

No, it wasn't St David's Day, but as Wordsworth would have said, "A host of golden daffodils" were presented to committee members at the annual general meeting as a special thank you for all their efforts during the past year. Gifts were also presented to five retiring committee members. Mrs Maureen Williams, retiring president, was presented by Mrs Ann Winchcombe, with a Dartington glass pansy vase, as a thank you from all the members for the tremendous effort and hard work that she had put in over the last five years.

Mrs Iris Rowe, acting as VCO, was in attendance, as also was Mrs Grace Bradford, trainee VCO. Mrs Rowe congratulated Porthleven on a very successful year, and praised their numerous innovative ideas, many of which she would be passing on to other WIs in the county. Both Mrs Rowe and Mrs Bradford were presented with bunches of daffodils, as also was Mrs Barbara Gray, as a thank you for all the birthday posies she had produced during the year.

The president's, secretary's and treasurer's reports were given, and the financial statement was duly adopted. The officers elected for the coming year were Mrs Ruth Mynheer, president; Mrs Jill Walker, secretary and Mrs Julie Corfield, treasurer.

The cup competition winners for the year as follows: 1, Jill Walker; 2, J Tilsley; 3, R Mynheer and Joy Stokes. Flower of the month (rose bowl): 1, R Mynheer; 2, J Walker; 3, S Mugford. The monthly competition winners for members craft were: 1, J Tilsley; 2, J Mills; 3, L Collins.

A birthday posy was presented to Mrs Barbara Gray. A raffle took place during the evening for the Denman College Bursary Fund, and tea and coffee monies collected during the evening were donated to the Mozambique Flood Appeal.

## Porthleven

### Duet

Mrs D Williams presided at the Porthleven Methodist Church Ladies' Fellowship and welcomed Pastor Graham Kitts as the speaker. A duet was sung by Mrs Coral Scott and Mrs Fuhrmann accompanied by Mrs M Williams and refreshments were served by Mrs D Williams and Mrs L Trace.

### Hall committee

Members of the Porthleven Public Hall committee will be holding their agm on Tuesday, April 18 at 2pm. Anyone wishing to attend will be most welcome. On Thursday, April 20, they have arranged a cake stall on the Harbour Head from 9am onwards.

### Coffee morning

A coffee morning for the local ARC was held on Saturday at the home of Miss Pauline Rosewarne of Mill Close, Porthleven and raised over £70.

MARCH

## RNLI branch raises £7,349 during year

FUNDRAISING activities over the past 12 months have helped the Porthleven and District branch of the RNLI raise a magnificent £7,349.

The figure was announced at the branch's recent annual meeting, which also saw chairman Brian Buxton make a request for new members, in particular some younger volunteers.

A plea was also made to local businesses with RNLI collecting boxes, who were reminded to let the branch know if they were closing down, or changing hands, so boxes could be emptied or reclaimed for future use.

The newly-elected committee was Brian Buxton, chairman, George Shipman and Grant Howard, vice-chairmen, Peter Trueman, secretary, Mike Carter, treasurer, Jean Lloyd, membership secretary, Pat Adams, souvenir secretary and Jean Howard, press secretary.

The branch recently held a fun evening at The Atlantic Inn, Porthleven, to raise funds for the crew of the Penlee lifeboat.

During the evening, Mr Buxton presented a framed service certificate to Mike Atkinson, the retired second coxswain.

Musical entertainment was enjoyed by all who attended, including members of the current Penlee crew, and the event raised £300.

● This year's Porthleven Lifeboat Day takes place on Sunday, August 27.

# New headteacher has fond memories of Porthleven

**THE woman named as the new head teacher of Porthleven School has said she is looking forward to returning to a school she considers to be a "very special place".** Penny Shilston, who is cur-

rently head teacher at Constantine School, was deputy head at Porthleven for two years before taking up the Constantine appointment in 1996.

She will return to the fishing port in September, taking up a position vacated last December by former head teacher Helen Williams, whose role is currently being fulfilled by acting head Paul Hunkin.

Mrs Shilston, who lives at Stithians, has been a teacher since 1976.

She said: "I have very fond memories of my time at Porthleven. It's a very special place, with a very special atmosphere, and I'm looking forward to being a part of that again."

"The school is very different now from when I was there. Incredibly, I think there is only one member of staff from my time who is still there."

"The important thing about Porthleven School is that it's such an integral part of the community. I shall be working to retain and strengthen those links."

Born in Devon, Mrs Shilston worked at a number of schools up-country, before settling in Cornwall 11 years ago - during which time she has also taught at Stithians and Mawnan Smith.

The difference in size between Constantine, which has 118 pupils, and

Porthleven, which has 238, was one of the main reasons behind her decision to move.

"I am looking forward to the challenge of a much bigger school, and one which also has a nursery unit. I have taught all ages from four up to 12, but teaching the early years is something very special."

"At Porthleven, I won't have the responsibility for one class which I have at Constantine. I will still be teaching - I'd never be able to give that up - but I will be teaching at every level."

Mrs Shilston said she would be "desperately sorry" to leave Constantine, which recently received a glowing Ofsted report from Government inspectors.

"At least I shall be going feeling I have put them on the right path. I am very lucky to have had my time at Constantine, because it too is a very special school."

"Years ago, head teachers were there for life, but I think it's good for the school to have changes in personnel. I can't deny I'm looking forward to moving on, but I shall be desperately sorry to leave Constantine."

Mrs Shilston is married to Mike, who works in the energy management unit at County Hall, Truro. The couple have two children, Oliver, 18, and Amy, 17.

A replacement head teacher for Constantine School has not yet been appointed.



□ Penny Shilston - returning to Porthleven School

## Porthleven

### Methodist Church

Mrs A A Vincent presided over the Porthleven Methodist Church Ladies Fellowship and was also the accompanist for the hymns and a solo by Mrs S Brown. Refreshments were served at the close.

### Wives Club

Mrs E Kitts, chairman, welcomed Mr R Bicknell, a retired Postal Officer to the Porthleven Wives Club meeting.

Mr Bicknell spoke about the history of The Royal Mail, and brought many photos of the Royal Mail, past and present, and explained how everything worked in this modern computer age. Thanks were expressed by Mrs J Birch and a welcome cup of tea was served at the end by Mrs A Phillips and Mrs E Richards. The next meeting will be on Friday April 28.

### RSPCA

An open evening for the local RSPCA was held at the home of Mrs S Young of Reeves Close, Porthleven, and raised £83 for their fund.

The raffle winners were Mr P Trueman, Mrs A A Vincent, Mrs E Williams, Mrs M Wright, Mrs G Diamond, Mrs L Thomas, Mrs M Hooper, Mrs S Howes, Mrs J Rosewarne, Mrs S Young, Mrs J Lloyd, Mrs V Trueman and Mrs L Willey.

The next event for the local RSPCA will be a coffee morning to be held at the Crab Pot Restaurant, on Wednesday April 26 from 10am-12 noon by kind arrangement with Mr and Mrs Sharpe, the proprietors. There will be the usual stall, raffle, and refreshments. All are welcome.

### Porthleven WI

"Oh Vi - I've had a disaster", prompted much laughter among members of Porthleven WI, at their monthly meeting, which was chaired by their new president, Mrs Ruth Mynheer. Mr Hunt, who started hairdressing 30 years ago, when the bouffant style was in its infancy, gave a most interesting and informative talk on "Hairdressing through the ages". From the red curls of Queen Elizabeth I, the cuckoo type head dresses of the Tudors to compliment hair, the most elaborate styles of the Victorians, the bonnets of Jane Austin showing little hair, right through to the 1900s, when short dresses and hair to match came into fashion. Tweeny twink home perms and the like then came on the market, thus encouraging people to experiment at home. Today, the styles of dress and hair are far more casual, and the natural look is encouraged. Asked what his worst moment was, he had to tell "Vi", as mentioned in the opening line, that her highlights had fallen off! Her reply - "Well it's a good job that I've got a lot of hair then" - in today's climate was quite amazing! A vote of thanks by Mrs Mynheer was given to both Mr and Mrs Hunt, who together successfully run the Myrtle Nurseries at Manaccan.

Competition winners were as follows:- 1st Jill Tilsley, 2nd Ruth Mynheer, 3rd Jill Walker. Flower of the month: 1st Jill Walker, 2nd Ruth Mynheer, 3rd Françoise Ziemann. Birthday posies were presented to Mesdames M Bernard, A Berry, O Richards, M Williams and F Ziemann. The tea hostesses for the evening were Mrs B Dinham and Mrs P Elderfield. Will members please note that the May meeting will commence at 6.45pm, instead of the usual time of 7.15pm.

## Porthleven

**WIVE'S CLUB:** Mrs E Kitts, chairman, welcomed R Bicknell, a retired postal officer, who spoke about the history of the Royal Mail and showed photographs of the organisation past and present. He also explained how the post office worked in the computer age. Thanks were expressed by Mrs J Birch and tea was served by Mrs A Phillips and Mrs E Richards. The next meeting will be on Friday, April 28.

**FELLOWSHIP:** Mrs A A Vincent presided over Porthleven Methodist Church Ladies' Fellowship. She was also accompanist for hymns and a solo by Mrs J Brown.

**RSPCA:** An open afternoon for the local RSPCA was held at the home of Mrs S Young, of Reeves Close. More than £83 was raised. Raffle winners were P Trueman, Mrs A A Vincent, Mrs E Williams, Mrs M Wright, Mrs G Diamond, Mrs L Thomas, Mrs M Hooper, Mrs S Howes, Mrs J Rosewarne, Mrs S Young, Mrs J Lloyd, Mrs V Trueman and Mrs L Willey. The next event for the RSPCA will be a coffee morning at The Crab Pot Restaurant on Wednesday, April 26, between 10am and noon.



Porthleven

Porthleven, with its narrow streets climbing the hillsides and its distinctive harbour, was once a centre for boat building. Nowadays, the village successfully combines the activities of a working fishing port with those of a popular holiday resort. This is indeed a happy mix, creating a village alive with gift shops and galleries trading alongside fishmongers, boatbuilders and chandlers.

Porthleven is also rapidly gaining itself a gastronomic reputation, such is the concentration of excellent places to eat and drink - and all within a few minutes' stroll of each other! And, to work off any indulgences, take a breathtaking coastal walk or relax on the sheltered beach, popular with families.

# PORTHLEVEN

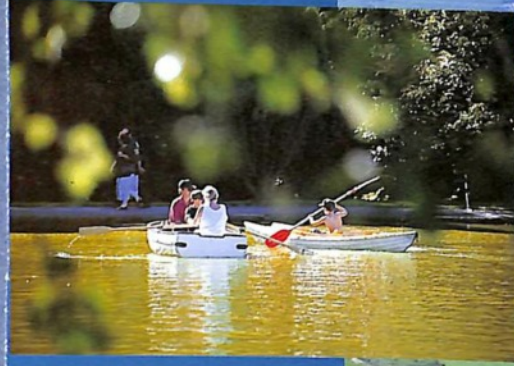

Coronation Lake



Flambards Theme Park

GOONGOOSE FARM ↗

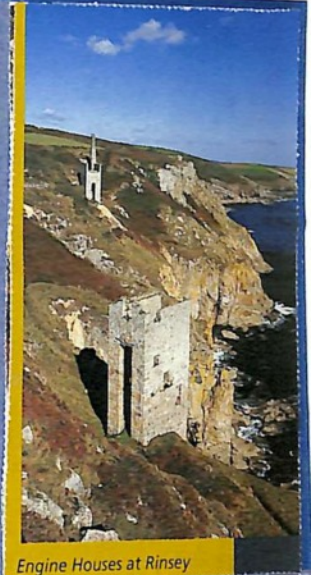
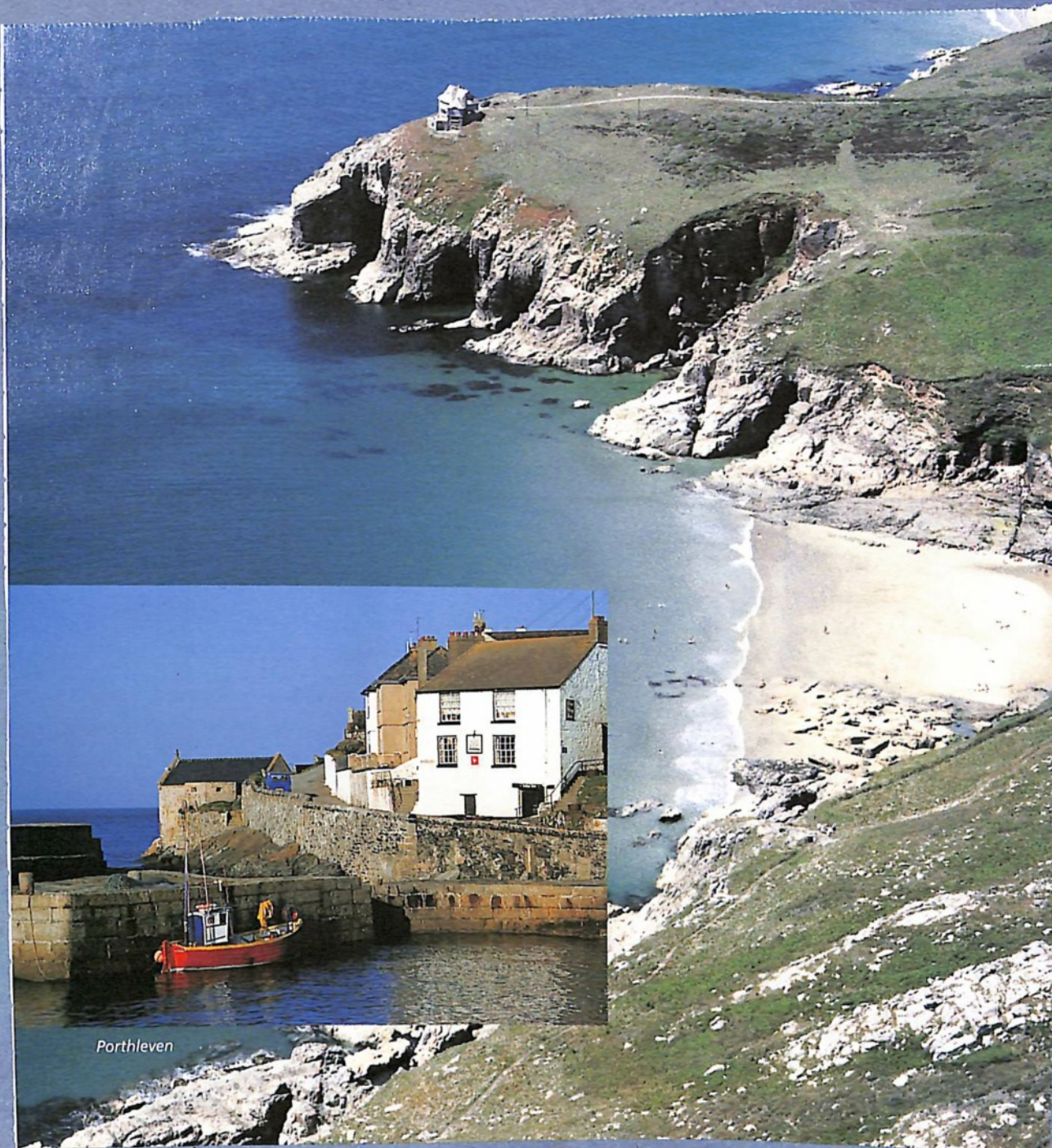

Engine Houses at Rinsey

Porthleven



Loe Bar & Loe Pool

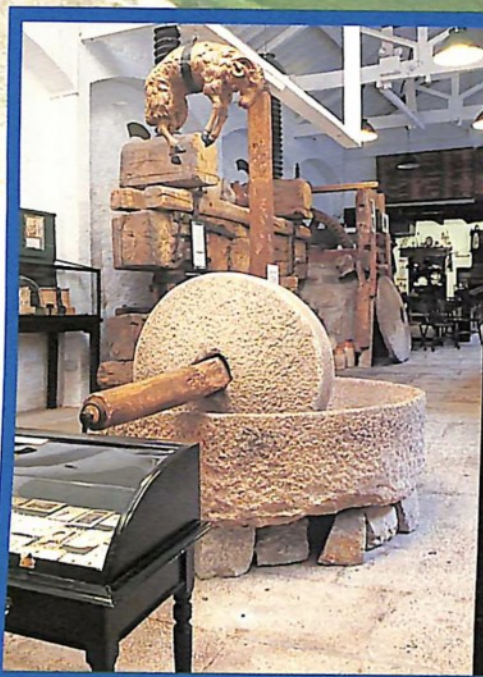

Helston Folk Museum



Loe Pool



PORTHLEVEN and LOE POOL



## Katie's seen three centuries

**BREAGE** House resident **Katie Mullin** (above) had three candles on her birthday cake on Sunday – one for each of the centuries she has lived in.

At the grand age of 103 and still going strong, Mrs Mullin was surrounded by friends at the weekend when she enjoyed a party organised by staff at the residential home.

One of a family of nine, she was born at Waltham Abbey, Essex, on March 26, 1897.

Moving to Porthleven 20 years ago with her daughter, Kathleen, who died in 1998, Mrs Mullin was an active member of the WI and local church.

She has a son, who lives in Canada, three grandchildren and six great-grandchildren.

Breage House owner, Harry Ring, said Mrs Mullin was pleased to have lived in three different centuries.

"It's quite a milestone," he said. "That's why we put three candles on the cake. She

enjoyed every minute of the party on Sunday. She was a bit down last year after the death of her daughter, but seems a lot better now."

Mrs Mullin, who enjoys the odd glass of Champagne, has attributed her longevity to drinking a cup of hot water first thing every morning.

APRIL 2600

## Porthleven

### Car boot sale

Members of the Porthleven public hall committee will be holding a car boot sale in the shipyard on Monday from 9am onwards. All bookings to Mrs R Williams on Helston 572937. Proceeds will go to the public hall fund.

### RSPCA

Twenty members and friends of the Porthleven Auxiliary of the RSPCA enjoyed a meal at the Wheel Dream Golf Centre for their annual get together. All arrangements were made by Mrs A A Vincent, their secretary.

### Fellowship

Mrs A A Vincent gave a very interesting talk to the Porthleven Methodist Church Ladies Fellowship and was thanked by Mrs C Andrews. Refreshments were served.

### Slide show

The public hall at Porthleven was packed for a slide show by Mr John Strike on Old Porthleven and raised over £213 for the local ARC. Mr Strike was welcomed by Mr Philip Smith and thanked by Miss Mary Davies. The evening concluded with a pasty supper.

## Seagulls are causing a nuisance

INVESTING in an ordinary dustbin instead of using plastic bags would greatly reduce the nuisance caused by seagulls in Porthleven, town clerk Elsie Balme said last week.

Mrs Balme was responding to the first of what she said was likely to be a "spate of complaints" about seagull nuisance in the village.

The resident who complained

suggested a petition be sent to Kerrier to get them to do something about the problem, but Mrs Balme said that would be a "fruitless" exercise because the district council had already said it would take no action.

Seagulls were a protected bird under the Wildlife and Countryside Act of 1981 and could only be controlled by authorised persons using authorised means.

Mrs Balme said: "Kerrier have confirmed to me it is a criminal offence to control gull numbers

purely because they cause a nuisance. They state categorically they have no plans to initiate any control measures."

It was suggested bait containing a substance which sterilised breeding birds could be put out - a practice used on the continent.

But using a proper dustbin and not putting rubbish out too early were the methods of control preferred by councillors.

Mrs Balme also urged members to help put up council posters asking people not to feed the gulls.

## Bygone days: Greg Nicholas recalls his youthful



HOW WELL I REMEMBER, THOSE WONDERFUL NIGHTS, IN THE PUBLIC HALL PORTHLEVEN. The world was our oyster, and yes they were the best band around.

## out bopping at the hop

THIS week's picture takes us back to the 1950s and the era of the dance band.

It features Raymond Rowe and his band, a group of swinging musicians who performed at local venues with foot-tapping enthusiasm.

The photograph was lent by Bert Rowe, of Helston, and it certainly brings memories flooding back.

I was a teenager when I attended my first Saturday night hop at Helston's Godolphin Club, and the band was none other than that pictured here.

The line-up from the left was Ronnie Rosewarne (sax), Raymond Rowe (sax), Freddie Philpott (drums), Pat Kitchen (accordion), Merville Matthews (piano) and Bert Rowe (accordion).

This picture was taken during a gig at Porthleven Public Hall.

Bert, who was Raymond's brother, said the band was going for about 30 years and that when Pat Kitchen left, his place was taken by Albert Watts.

"We used to do three or four dances a week," said Bert, who

made his debut with the band when he was 15. He is now a sprightly 76 and still plays the accordion for his own enjoyment.

In those days, Saturday night at the Godolphin Club was a must. Before the club boasted a bar, Charlie Hannaford, of the Seven Stars pub, often provided one for dances.

Such bands as Raymond Rowe's attracted full houses and everyone had a ball - excuse the pun.

Meanwhile, our recent picture of a Helston football team (vintage 1925-1926) drew a great response with readers soon on the telephone or calling into the office to tell me the names of all those featured.

The group comprised Charlie Wearne, Mr Wills (who ran an eating house in Coinagehall Street), "Whisky" Ashton, Granville Rogers, the Rev Johnson, Rowe, Andrews, Gus Hendy, George Nicholas, Peter Richards, Reg Simpson, Billy Rickard, Leonard Philpott, Coco Bray, Edward Cunnack, Edward Angove and Freddie Philpott.



## Extension plans: Methodists want work to benefit the whole community



● The Rev Robert Ormesher and Sunday school teacher Vanessa Williams in the chapel. Picture - Colin Ross

# Chapel aims to embrace all

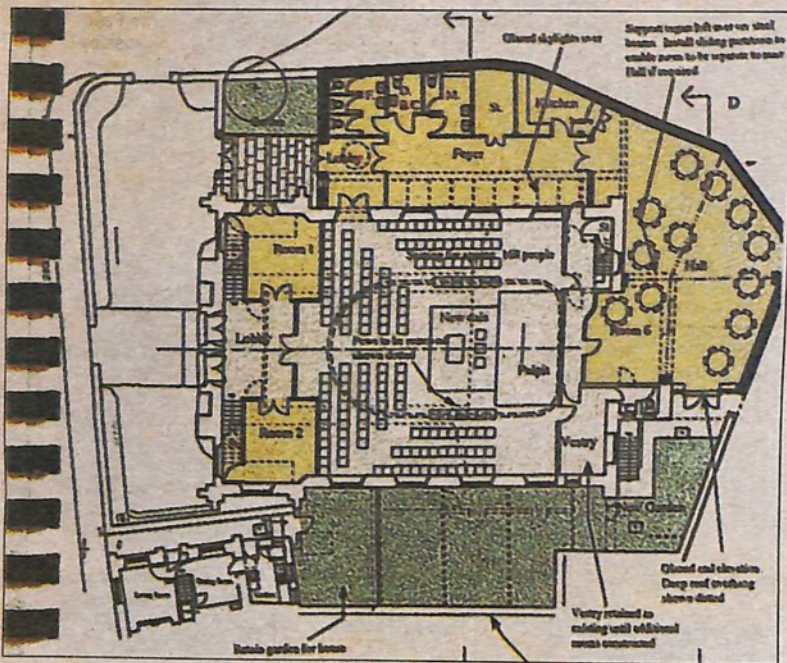

● Plans for the proposed extension and refurbishment of Porthleven Methodist Church.

A £500,000-PLUS redevelopment project has been launched by Porthleven Methodists for improvements to their Fore Street chapel, which they want to share with others in the local community.

The idea is to add extensions at either side and at the rear of the chapel to provide a hall, new toilets and a new kitchen, as well as access for disabled people which community groups could use as well as chapel members.

Changes would also take place inside the chapel itself, with the creation of a platform area underneath the pulpit which could be used for drama, dance or other performances and events.

Architects' plans have been sent to Kerrier Council, seeking planning permission, and

By Muriel Cato

to the property division of the Methodist Church which will have the final say on internal alterations such as removing any of the pews.

Already more than £90,000 has been raised in promises of grants and local fundraising, said David Balme, secretary of the chapel's redevelopment committee.

He is now busy applying for other grants such as Objective One funding, and events are planned to raise more money, including a "Jazz in June" concert at the chapel, a silent auction, coffee mornings and evenings, and garden parties.

The total cost of the project is £543,000, and 115 chapel members are attempting to raise around £1,000 a head each.

The chapel already attracts many to its services.

On Sunday mornings, between 90 and 100 people attend, with around 50 for the evening services, while the number of youngsters in the Sunday school is growing.

However, as Mr Balme pointed out, the aim of the project is not just to provide modern facilities including a hall for the chapel members, but for groups in the community as well, including members of the parish church congregation.

"The whole project would provide another focus for community life in the village.

"It is not just for us but to make the chapel available to everyone in the community," he said.

"There is a scheme for regenerating Porthleven and we hope to be part of that."

## Tidy up for signs

SIGNS welcoming visitors to Porthleven are to be given a fresh coat of paint after local resident Michael Gale alerted the town council to their poor state of repair.

Godfrey Stephens suggested the signs be stored away during the winter but John Strike said the tourist season extended into the winter, and with a good coat of varnish the signs should be able to be left out all year.

## Porthleven

### Ladies Fellowship

Mrs A A Vincent presided over the Methodist Church Ladies Fellowship and welcomed Mrs Amy Pascoe from Sithney who gave a very interesting address. A solo was contributed by Mrs Willey accompanied by Mrs Vincent, and refreshments were served at the close.

### Wives Club

Members enjoyed a talk by Mr Paul Bannister of Porthleven with his dog Kitts. He spoke on the work of the guide dogs for the blind, and gave a very interesting account of his cycle ride through Cuba. Mrs Eleanor Goldenbaum presided and welcomed Mr Bannister, and Mrs Joan Ford thanked him. Refreshments were served at the close.

### Coffee Morning

A coffee morning will be held in the public hall on Saturday, May 20 from 10am - 12 noon. There will be a bring and buy stall and raffle, and all proceeds for the public hall refurbishment fund. Your support will be appreciated.

### RSPCA

The first summer stall for the local auxiliary of the RSPCA held on the harbour head raised £123.50 for their fund. The next stall will be on Thursday, May 25.

# Legion revival

ATTEMPTS are being made to revive the men's section of the Royal British Legion in Porthleven, disbanded several years ago due to the increasing age of its dwindling membership.

The village has been without a branch of the legion since the women's section also disbanded following Remembrance Day commemorations last year.

Now town councillors and former servicemen Jim Stokes and Michael Crowle are trying to drum up interest in re-forming the branch.

Mr Crowle said this week a number of people had already expressed interest in the proposal, but it was hoped more would be forthcoming.

Mr Crowle and Mr Stokes can be contacted through the council offices at the Institute in Porthleven.

# Church stalwarts celebrate diamond anniversary



□ Gordon and Kay Rowe – never kept a secret from one another

DEVOTED Porthleven couple Gordon and Kay Rowe saw their Tregunna Close home inundated with well-wishers when they celebrated their diamond wedding anniversary on Monday.

Stalwarts of Sithney Church, where Gordon has been churchwarden for more than 20 years, the diamond couple were given a special mention during services on Sunday.

They also enjoyed a celebratory lunch at Porthleven's Harbour Inn with family and close friends, including fellow churchwarden Eric Mildren and his wife, Peggy, and Sithney vicar Father Peter Walker.

Gordon, 82, and Kay, 87, were married at Perranuthnoe Church on May 8, 1940 – three months after

Gordon volunteered for the Royal Army Service Corps.

Born in Praze-an-Beeble, he moved as a child to Gulval, where he later met Kay at the parish's Methodist chapel.

A Gulval girl herself, Kay worked at the local flower farm, while Gordon was in farm service.

When he returned from the war in 1946, the couple lived at Godolphin, where Gordon became churchwarden.

Moving house to Carleen, and then to Sithney, they joined St Sithney Parish Church in 1961 and have attended regularly ever since.

Gordon initially worked for a local firm selling animal feed, before moving to Olivers the butchers in Helston, where he became

manager and remained for 15 years until retirement.

Treasurer of the Royal British Legion at Breage for 25 years, he is also a life member of Porthleven Bowling Club.

After 60 years of married life, Gordon and Kay have no doubt what it is that has made their relationship such a success.

"God's blessing and love. It's as simple as that," said Gordon. "We've never kept a secret from one another, and we've never gone to bed on a quarrel. We do everything together. I love her as much now as when I first fell in love with her."

The couple have three sons, Hugh, David and Roger, who all live in Helston, six grandchildren and two great-grandchildren.

## Talking to each other has been key to success

KEEN photographers Doris and Ted Murphy are likely to be on the other side of the lens tonight when they celebrate their diamond wedding anniversary with friends from Helston Camera Club.

Married on May 11, 1940, the couple, who live in Methleigh Parc, Porthleven, will be marking their special day at a social evening organised by the club they have been members of for almost a third of their married life.

Ted, 83, who comes from Newcastle-on-Tyne, met and married Doris, 81, in her home town, Carlisle.

The couple first came to Cornwall in the 1960s when Ted, who spent 27 years in the Royal Navy, was posted to Cudrose.

After various postings both at home and overseas, the Murphys were so taken with the climate and the pace of life in Cornwall they decided to build a home in Porthleven.

After retiring from the Navy in 1970, Ted was a technician in the art department at Helston School for around ten years until his retirement.

Doris, a primary schoolteacher, did supply work at numerous schools in the Helston and Lizard area – later becoming

a lunch-time supervisor at Porthleven School. Their daughter, Gillian, who was the first girl from Helston Grammar School to go to Oxford University, was married at St Michael's Church, Helston.

Up until just over a year ago, Ted was vicar's clerk at St Michael's Church, working for vicars John Woollan, Harvey Pentreath and David Miller during the 30 years he held the position.

Doris, who was a member of Porthleven Tennis Club, also used to run a Scottish dancing group in the village.

As well as a shared interest in photography, the couple enjoy gardening and travelling, and have taught themselves Spanish from borrowed school books.

They are fans of the radio and don't own a television – in spite of having won three in consumer competitions over the years, which have also netted them a couple of cruises and numerous other prizes.

Their good fortune, which Ted puts down to his skill at writing slogans, is not something they consider when asked what has kept them together over 60 happy years.

"A sense of humour and trusting each other," said Doris. "And no TV – when you haven't got a TV you have to talk to each other!"



□ Doris and Ted Murphy – don't own a TV despite winning three

MAY 2000

## Timber from former lifeboat could be used for garden sculpture

TIMBER from Porthleven's former lifeboat, the *Dash*, could be used to create a model or sculpture for a public garden overlooking the harbour, town councillors suggested last week.

Members have for some time been discussing the future of the *Dash*, currently lying in the shipyard at Porthleven, and whether or not it would be feasible to restore the ageing vessel.

The idea was put on hold last year when Dave Blanning told colleagues a project to restore a similar lifeboat at Polperro had cost £70,000.

At a town council meeting last week, clerk Elsie Balme said the boat would continue to deteriorate if it remained where it was, and in any case shipyard owner Trevor Osborne wanted it removed.

Mrs Balme said opinion remained divided on what to do with the *Dash*. "While everyone would be extremely sorry to see it scuttled, there is a strong body of opinion which thinks this is the only possible fate for it.

"Some still believe it could be

saved – at a cost – but then we would have to find somewhere to put it under cover until we could raise the funding to deal with it, possibly from a maritime trust."

Charles Budd said making a model of the lifeboat from the original timber and installing it in the millennium garden to be sited at Frankie's Allotment was an "excellent" idea.

"It would be a more fitting bit of art than a rampant lion, or whatever it was suggested could be put there," he added.

A sculpture of some kind has always been included in the design for the garden, which recently won planning permission from Kerrier district council.

John Strike said it would be a "crying shame" to see the *Dash* burned, but bits were already being taken from the boat.

"If I was retired I would love to do it up because it could be restored to its former glory quite easily," he said.

Members agreed to place an advertisement seeking anyone keen to take on the restoration, and in the meantime approach Mr Osborne's Harbour and Dock Company with the suggestion for the public garden.

## Porthleven

WI

Members of Porthleven WI were treated to a highly amusing and lighthearted account of the joys or perils of buying and restoring a Cornish Cottage, by Miss J Harris, at their May meeting.

From a bathroom, decorated with brown paper, disguised with paint which produced a blue haze and disintegrated in the steam, to an electric kettle which flashed and smelled of cordite, which finally went bang due to faulty electrics, and had to be renewed, a kitchen sink which parted company with the wall and came off in her hands, a central heating system with a leaking bathroom radiator and was decidedly dodgy, to a swaying staircase made of clipper tea chests, which had to be demolished – to name but a few of the many problems!

Fleas were a major source of annoyance – even the cats refused to venture upstairs! The problem was only resolved when a helicopter obligingly hovered a little too close – she could even identify the pilot's clothes down to the colour of his socks, and the roof gave up the ghost along with the fleas!

Despite all the problems though, it was her cottage, it enveloped her, and she loved it wholeheartedly.

Mrs Rose Williams gave a report on the refurbishment of the Public Hall, and asked for support by WI members for further fundraising to complete the final phase.

Two of the resolutions were voted on and given unanimous support – Post Offices – Benefit and Pension payments to be continued, and more help for stroke victims needed, but the funding of Children's Hospices was left in abeyance, it was felt that an amendment might be forthcoming. Mrs J Mills VCO was in attendance, and she spoke eloquently on each of the resolutions. She was thanked, and presented with a bouquet of flowers by Mrs Ruth Mynheer (president).

Mrs Maureen Williams was asked to report on the millennium seat presentation, which successfully took place on April 17, 2000.

A birthday posy was presented to Mrs Judith Richards. Mrs Janice Mills (Committee Member), who will shortly be moving to Sidmouth, was thanked for her work, and presented with a gift to remind her of Porthleven.

Mrs Jill Tilsley was presented with a certificate for gaining 1st prize in the craft section at the Spring Council Meeting.

Flower of the month: 1 – Jill Walker, 2 – Ruth Mynheer, 3 – Angela Rogers.

Competition of the month: 1 – M Bernard, 2 – J Tilsley, 3 – J Stokes.

A BUS shelter in Porthleven which has been described as a disgusting eyesore is to be demolished at the end of the month.

The condition of the shelter, on Wellington Road, has long concerned town councillors who, after hearing Kerrier had no money available to refurbish the structure, decided to fund a new one.

A competition was launched to give villagers a chance to design their own shelter, but only two entries have so far been received by town clerk Elsie Balme.

Council vice-chairman Charles Budd said the designs should be looked at as soon as possible in case they were not suitable and the work had to be put out to tender.

Godfrey Stephens said consideration should also be given to the exact location of the new shelter, particularly as the layby and bus stop had been moved to avoid the bus parking on a junction.

Members agreed to discuss the designs submitted at a meeting this week.

The district council is due to demolish the existing shelter at the end of May.

## Honour for Alfred: Prisoner of war stayed and created beauty



● Flora Day held an extra reason for celebration for Alfred Poeplau, whose work at Lismore Gardens was deemed worthy of an award by the Flora Day Association. Picture - Colin Ross

A PORTHLEVEN resident who arrived in Helston as a prisoner of war and decided to stay in the area has been honoured by the Flora Day Association.

He is Alfred Poeplau, aged 76, who has been presented with a framed certificate of excellence in recognition of his dedicated service in the preparation of Lismore Gardens over the years.

Alfred, who has been gardener at Lismore since 1956, was serving with the German Navy as a wireless operator on a lighthouse in the Channel Islands when he was taken prisoner by British troops.

"The British moved in a week after the war ended and reclaimed the islands," he said

He was later transferred to Helston, where he stayed at

Nansloe Manor for 12 months, and was put to work on local farms.

"I could not speak a word of English apart from yes and no," said Alfred. But he fell in love with the area and its people and decided he did not want to go back to Germany. He met his wife, Violet, who has lived in Cornwall most of her life, and settled here, where he has made many friends.

He was taken on at Lismore by the late Dr James Patterson Michael and his wife, Edna, and has remained there ever since.

He now works part-time for the present owners, but still keeps the gardens in tip top condition.

During his spare time, he likes nothing better than to play euchre and is a regular at drives held at Helston Royal British Legion.

## Money to be loaned for public hall work

PORTHLEVEN town councillors have agreed to loan money to the management committee of the village's public hall to cover an outstanding bill for refurbishment work at the premises.

Members heard the final phase of improvements at the Wellington Road hall had gone £3,000 over budget due to requirements from Kerrier district council's building regulations section.

That money needed to be raised at short notice, and although the committee had organised various fundraising events, it was seeking further financial support from the town council.

Urging colleagues to respond to the request, Michael Crowle said the hall was used continuously and the improvements were enjoyed by a large sector of the community.

Members agreed to pledge an initial loan of £1,000, with the possibility of a further loan if the bill had to be paid urgently.

Chairman Dave Blanning said that, with support from the council behind them, he was confident the hard-working management committee would succeed in raising the rest of the money.

● Former chairman Katherine Williams has been appointed as the council's representative on the hall's management committee.

Charles Budd's proposal that the person appointed be a non-voting representative was not supported by members.

# Violin fetches £3,000 at Helston sale

A VIOLIN left on a whim at a Helston auctioneers was sold this week for £3,000.

The Italian-made instrument, dating from the 1920s or 1930s, was dropped off at Helston Auction Rooms in Trengrouse Way last month by a man from Porthleven.

Linda Edwards, who runs the auctioneers, said there had been no indication of the violin's worth.

By Laura Parsons

"The person who brought it in turned up here and said 'I don't know if you can get anything for it'. Violins always sell, but normally only for a few hundred pounds. We had no idea what it would go for."

The violin - a Claudio Gamberini - came complete with velvet-lined wooden case and two bows. Formerly played by Ronald Smith, a member of the Bournemouth Symphony Orchestra, it was put up for auction by a relative of Mr Smith.

A digital photograph of the instrument was displayed on the internet and interest in it quickly became apparent.

Potential buyers travelled from as far afield as South Wales and Berkshire to

view the violin, and Monday's sale saw lively bidding both in person and on the telephone.

"There was no reserve price on it, but someone had left a bid of £310 after seeing the photo, so we really didn't know what to expect," said Mrs Edwards.

"I was getting excited at £2,000, but when it got to £3,000 we were pinching ourselves!"

The eventual buyer - an international dealer from Wales whose mother lives in Penzance - said the violin was a fine example of its type and would probably go to Korea or Japan, where there was the best market for such instruments.

The dealer told Mrs Edwards the last time a similar model had come up for sale ten years ago in London it went for £2,400.

### Porthleven

#### Ladies Fellowship

Mrs A A Vincent presided over the Porthleven Methodist Church Ladies Fellowship and invited each member to participate in a reading or musical item which made a very enjoyable afternoon. Refreshments were served at the close.

#### Ladies Circle

Members of the Porthleven Ladies Circle enjoyed their monthly activity when they visited the Tehidy Woods for a walk around the grounds. Arrangements were made by Miss Phyllis Arthur.

#### Coffee morning

A coffee morning for the Porthleven Public Hall was held on Saturday and realised £93 for the Public Hall refurbishment fund.

MAY  
2000

## Council to pay towards upkeep of public garden

PORTHLEVEN town council is to pay £500 a year towards the upkeep of a public garden to be built on derelict land overlooking the harbour.

The £130,000 millennium garden will be created at Frankie's Allotments, on Breageside, land owned by the Porthleven Harbour and Dock Company.

Company boss Trevor Osborne has agreed to lease the site to the Porthleven Millennium Trust, which initiated the project several years ago.

Town clerk Elsie Balme told councillors last week the trust had asked the council to consider giving an annual sum, largely towards maintenance of the garden.

A "discretionary" grant, said Mrs Balme, would preserve the site for the enjoyment of locals and visitors and would undoubtedly be cheaper than if the council was responsible for rent, insurance and maintenance.

Vice-chairman Charles Budd said what amounted to less than £10 a week to preserve the garden, and remove for good the eyesore that the site had become, was hardly extortionate.

Members agreed to make two payments a year, with the first installment when the garden was completed.

The grant would be reviewed on an annual basis depending on the standard of maintenance and would continue for the lifetime of the council provided standards were upheld.

● Nothing can be done to prevent youngsters damaging a piece of land off Loe Bar Road, described as an "eyesore", unless the owner complains to the police, Porthleven councillors heard last week.

Jim Stokes said children were pulling down the wall and the stones were falling into the road, which could be dangerous.

Jill Green said the landowner would be happy to sell the plot, but there was little it could be used for apart from building a house.

● Police figures for the preceding month for Porthleven were 40 calls, nine crimes and three arrests, compared to 58 calls, six crimes and two arrests in the same period last year.

Members heard the crimes recorded were three burglaries, two thefts from vehicles, one damage to a vehicle, one theft of a vehicle, one harassment and one dangerous dog.

Reading out the information in the absence of a police officer, town clerk Elsie Balme said the figures appeared to be keeping "fairly level".

● The council's community newsletter is to be resurrected after an absence of several months.

Jill Green is to work with Mrs Balme to produce the newsletter, probably every six months.

● Members awarded grants of £25 to the Helston and District Victim Support group and to the Friends of FLEET, which provides emergency equipment used by ambulance crews.

MAY 2000

## A PORTHLEVEN man has been awarded an OBE in the Queen's Birthday Honours List.

Andrew Bell, who lives with his family on Breageside, was honoured for services to the British Overseas Territory of St Helena, in the South Atlantic.

Mr Bell, who set up Curnow Shipping with Simon Sugrue from Cadgwith, left the company in a boardroom shake-up last year after 25 years as managing director but his involve-

ment with the remote island of St Helena was deep-rooted. Initially based in the shipyard at Porthleven, and now in Killigrew Street, Falmouth, Curnow Shipping has become well known in the maritime industry.

During his time at the helm, Mr Bell won and successfully oversaw the running of three contracts to operate the *RMS St Helena* on behalf of the British Government and it was a surprise when he left the company last year.

One of only two Royal Mail ships still in service, the *St Helena* is the only regular link to the outside world for the people of St Helena. During 1982, an earlier vessel of the same name was called into service by the Ministry of Defence following the Falklands crisis and had a heli-pad fixed to her stern.

Mr Bell is a former Helston town councillor and deputy mayor during a period prior to Porthleven becoming a separate parish.

Since leaving Curnow Shipping, Mr Bell has formed Anden Limited, a shipping and internet consultancy based at Porthleven ship-

yard. The business undertakes shipbroking projects and is also involved in designing web sites for companies across the globe.

Mr Bell currently holds a number of positions including deputy chairman of the Falmouth Harbour Commissioners.

Learning of the OBE while on holiday in North America, he said: "It is a great honour to be recognised in such a way by Her Majesty. I shall endeavour to continue to serve the country and the people of St Helena as well as I can."

# Cliffhanger concluded

TWO years after a devastating storm wreaked havoc at a cliff-side hotel in Porthleven, a major engineering project has given the property a new line of defence against the sea.

Six months' work, and in excess of £300,000, has stabilised cliffs beneath the Tye Rock Hotel, on Loe Bar Road, and transformed the swimming pool, extensively damaged in the storms of January 1998, into a stunning new garden.

Owners Richard and Pat Palmer, who have been at the Tye Rock since 1995, say the completion of the project has come as a huge relief.

"The past two years have been

really hard, but we are now looking forward to the future," said Richard.

"The contractors, Dean and Dyball, and everyone involved with the project have been wonderful, and we are delighted with the finished product.

"In the end, the storm damage turned out to be something of a blessing in disguise, because we have successfully re-imagined the hotel as an up-market country house where people can enjoy total peace and quiet."

Much of the work needed to shore up the unstable cliff was carried out by deep drilling experts who had been working on the Eden project.

The massive feat of engineering involved drilling rock pins up to 15 metres into the cliff face and covering the exterior with steel netting secured with almost 100 two-metre-long rock pins.

Another repeat from Eden was the liquid hydrograss sprayed

onto the cliff face, growth of which has been delayed by salt spray but which should eventually produce a tough covering of grass.

There will be an opportunity to view the result of the work, including the newly-created star gardens, when the Palmers hold a formal opening event next month in conjunction with the Lizard Peninsula Tourism Association.

TV scriptwriter and regular Tye Rock guest Phil Ford will perform the honours on Sunday, June 4, when there will also be a rescue demonstration by a Culdrose helicopter and a lifeboat, a Punch and Judy show and music from Porthleven Town Band.

Proceeds from the event, which takes place between 1pm and 3.30pm, will go to the RNLI and the band.



□ ABOVE: Richard Palmer inspects the damage caused by the storm in 1997



RIGHT: The Palmers today in the stunning new garden after completion of the mammoth engineering project

## Steven's run boosts RNLI



STEVEN Richards, of Porthleven, raised just over £300 for the RNLI when he completed this year's London Marathon in three hours and 58 minutes.

Now the proceeds from his run were presented to the Porthleven and Dist-

riect branch of the charity at the Atlantic Inn.

RNLI members congratulated Steven on his achievement and thanked him for his efforts.

He is pictured above with George Shipman, left, and RNLI treasurer Mike Carter, right.

## Porthleven

### Coffee morning

A coffee morning was held in Porthleven public hall on Saturday and raised over £264 for the League of Friends of the Helston Community Hospital. There was a cake stall,

bring and buy and a raffle. Arrangements were made by Mrs Barbara Gales and she wished to thank everyone for their help and support.

### Ladies' Fellowship

Rev R Ormesher was the speaker at the Porthleven Methodist Church weekly Ladies Fellowship, and the afternoon concluded with refreshments.

### Ladies Circle

Members of the Porthleven Ladies Circle visited the Roskilly's Ice Cream Parlour at St Keverne for their monthly activity where they enjoyed a walk around the grounds and the evening concluded with refreshments.

### Summer Fete

The annual summer fete for St Bartholomew's Church, will be held on the Harbour Head on Tuesday, July 25 from 10am - 4pm. There will be stalls, games and raffle and hot dogs. All proceeds for church funds.

### Street collection

The recent street collection in Porthleven for the Alexander Rose Day appeal amounted to £217.66 with £174.30 of this amount being donated to the Porthleven public hall refurbishment fund.

### Blessing

The annual service of The Blessing of the Sea will be held in Porthleven on Sea Sunday, July 9 commencing at St Bartholomew's Church with solemn mass at 9.30am. This will be followed with members of the Porthleven Town Band leading a procession from the church to the harbour for the traditional blessing ceremony at 10.30am.

### Concert

A concert will be given in St Bartholomew's Church on July 16 at 8pm by the Praze Male Voice Choir and the Liskeard Ladies Choir. Tickets are £2.50 each, and all proceeds for the local Arthritis Research Campaign.

### Age Concern

Members of Age Concern, will be holding their annual fete on Porthleven Harbour Head on Thursday, July 13 from 10am onwards with various stalls and a raffle.



□ This larger photograph features ... **FIRST ROW:** fourth left; Tom Willey, sixth left; ? Laity **SECOND ROW:** first left; Tommy Bowden, second left; Edgar Hosking, third left; Alfred Frost **THIRD ROW:** centre; Mark Williams **FOURTH ROW:** second right; Frank Laity, third right; Charles Hosking **BACK ROW:** far right; ? Matthews

# First World War photos feature familiar faces

**THESE** two pictures from the First World War, loaned to the *Packet* by Margery Elliott, of Porthleven, feature names and faces that will undoubtedly be familiar to many living in the port.

Margery's father, Porthleven fisherman Frank Laity who appears in both the photographs, joined the Royal

Naval Reserve before the outbreak of war, travelling regularly to Devonport for training in his early 20s.

Margery believes the smaller group picture, (*below right*), was taken at the beginning of the war, although she has no idea where the men, all from Porthleven, were posing.

Judging by their caps, they were serving with HMS Argonaut, and the wooden horse one of them is sitting on was perhaps a mascot.

Only one of the names escapes Margery, who remembers most of the men from her childhood in Porthleven.

The larger group, whose caps bear testament to their role in the Royal Naval Reserve, is believed to have been photographed towards the end of the war, possibly at Devonport.

Margery is able to name most of the Porthleveners in the picture, but there are one or two gaps.

JUNE

## Aerial displays marks opening of gardens



□ Phil Ford, Sarah Buck, and Pat and Richard Palmer

AN aerial display by a helicopter from RNAS Culdrose was the highlight of a charity event staged to mark the opening of new gardens at a cliff-side hotel in Porthleven.

More than 300 people gathered in fine weather at the Tye Rock Country House on Sunday to view at close quarters the transformation of the hotel swimming pool, which was badly damaged in severe storms two years ago.

The newly-landscaped Star Gardens were officially opened by TV scriptwriter Phil Ford and consulting engineer Sarah Buck, who designed the gardens.

Entertainment included music from Porthleven Town Band and the

Old Glory Jazz Band, a traditional Punch and Judy show and an appearance by Porthleven gig club, who rowed past the Tye Rock accompanied by dolphins and a basking shark.

But it was the sudden arrival of the Sea King - only recently returned from assisting a fishing boat taking on water off the Scillies - which most impressed the crowds.

"We were really privileged that Culdrose came out when they'd only just come back from a real-life shout," said hotel owner Richard Palmer.

"It was a brilliant display, and the highlight of a wonderful afternoon."

Organised in conjunction with the Lizard Peninsula Tourism Association, the event raised around £400 for the RNLI and Porthleven Town Band.

(Granddad.)  
Charles  
Garfield  
Eddy.

My Grandad on my Mothers Side  
Tommy Bowden was my  
Grandads cousin. & Tom Willey  
married one of his Aunties

JUNE 2000.

HP THE PACKET Week ending June 24, 2000 11



□ Goodbye to all that ... front middle (l-r) Angela Mitchell, David Mitchell, Tony Richards, Dee Richards and Demelza

## Band say fond farewell to director

MEMBERS of Porthleven Town Band have said farewell to musical director Tony Richards, who is handing over the baton after three years due to increasing work commitments.

At a special presentation

evening at the Harbour Inn last Friday, band president David Mitchell gave Mr Richards a framed memento signed by all the band members.

Mr Richards' wife, Dee, was presented with a bouquet by the

youngest member - nine-year-old Demelza Christophers.

Mr Richards, who will be succeeded as musical director by Francis Evans, wished the band well for the future.

Frankie's Allotment Garden.  
*Kerrier Council have now given Planning Permission for this garden, and the Millennium Trust hope shortly to receive the funding so that work can commence. The landscape architect is well aware of the need to make the garden suitable to the area in which it is, and the plants there will be chosen with their seaside situation in mind; salt-tolerant, wind-resistant and appropriate to Porthleven. Hopefully many people will be able to spend many happy hours sitting in the garden looking down over our harbour and enjoying the day.*

**PORThLEVEN - SITHNEY - GUISSENY TWINNING ASSOCIATION.**

At the AGM on the 18th April 2000, the following officers were elected:-

President (ex officio) Councillor David Blanning, Chairman, Porthleven Town Council

Chairman: Mr. Vincent Curnow.

Vice-Chairman: Mr. Godfrey Stephens

Secretary: Mr. David Moon.

Treasurer: Mr. George Shipman.

A party of 12 left on Wednesday, 31st May to visit our twin village of Guisseny, returning on the 4th June. As usual, our hosts had arranged a full programme of receptions and visits to places of interest, and a splendid family hospitality was

enjoyed

A mirror/clock, specially designed and hand-crafted by the Cober Valley Stained Glass Studios, was presented to the people of Guisseny to commemorate the new Millennium.

The Association would welcome new members. Meetings are held in Porthleven Football Club's headquarters at Methleigh Mill on the 3rd Tuesday of each month at 7.30pm. (Next meeting, Tuesday 20th June). Annual subscriptions are only £2 (£3 for family membership). Please join us in arranging and taking part in a range of very enjoyable social and other events during the coming year.

**ROYAL BRITISH LEGION.**

As most of you know, both the Men's and Women's Branches of the Royal British Legion in the village have had to close down in recent times for lack of members. This does seem a pity, given the large number of ex-service personnel who live here, and it will be a shame if we have to mark Remembrance Day this year without the Legion to lead us. Two of our Councillors (Councillors Stokes and Crowle) would like to know the names of anyone who would join (or re-join) a new Porthleven branch. If a viable number can be found, then the matter can be put in hand. Come on all you ex-Navy, ex-Army and ex-RAF people - help us to get the Legion re-born and work for the causes for which it stands.

**Porthleven Methodist Church** has now begun to raise funds for its ambitious re-development scheme, which will see not only necessary repairs to the front of the building, but extensions to the side and the rear, comprising new kitchen, toilets and meeting rooms, with some careful alterations to the worship area. The plans for a dais beneath the pulpit and the re-alignment of some of the pews are intended to create an atmosphere where families and young people will feel at home in God's house, yet still retain those features valued by conservation bodies and heritage groups. Although permission has still to be obtained for these works, current funds available exceed £90,000, and requests for assistance are being made to numerous Trusts and charities. The estimated total cost is in the region of £543,000. The single most important source of funds is likely to be under Objective One and in order to qualify for this money, as well as to meet the probable town need for some small units for use by the community, it is proposed to construct three rooms on the southern side of the church for commercial and community uses, such as computer rooms, surgeries for blood donors, job seekers etc. To assess the need for these local facilities, businesses will be canvassed during the summer to discover local requirements. All helpful suggestions from the public are also welcome. So if you feel that a local need could be met in this way, please contact the minister, Rev. Robert Ormesher (562233) as soon as possible.

**FUNDRAISING EVENTS FOR PORThLEVEN PUBLIC HALL REFURBISHMENT - 2000.**

June 7th. Sponsored Swim - John Williams (Project Officer) and others.

June 17th. Alexandra Rose Day Street Collection (80% of amount collected for Public Hall Funds).

July 15th. (11am) Coffee morning and presentation of clock by Porthleven Wives' Club.

July 27th. (from 9.30am) Cake stall - harbourside.

August 17th. Harbour Head Fete followed in the evening by a Slide Show in the Hall by Mr. John Strike.

**SEPTEMBER (DATE TO FOLLOW). OFFICIAL RE-OPENING OF THE HALL.**

**PORHLEVEN TOWN COUNCIL  
NEWSLETTER, Edition 2, No. 2.**

*"Never apologise. Never explain" we are told. Notwithstanding this good advice, we are sorry that it has taken so long to get back into print, with only one newsletter during the past year. Hopefully the problems which caused the delay have now been overcome and things will run more smoothly.*

**Changes at the Council.**

*After a very busy and hardworking year as our Chairman, Katherine Williams has now retired from the Chair. She is succeeded by David Blanning, who has already represented us at several local functions, and will shortly be visiting Guissey to meet the Mayor of our Twin Town. We should like to wish David a happy and successful year in office, and to thank Katherine for all her hard work. She will continue to represent us as a School Governor and also as a member of the Public Hall Management Committee. Charlie Budd remains our Vice Chairman. If you have any problems with which you think the Council might be able to help, please do not hesitate to contact one of the Councillors (names listed in the next column) or the Town Clerk (01326 573154). The Town Office is open on Tuesday, Wednesday, Friday and Saturday, from 10am -12.30pm.*

**PORHLEVEN'S TOWN COUNCILLORS.**

Cllr. David Blanning	4 Fore Street
Cllr. Charlie Budd	Sandpipers, Loe Bar Road
Cllr. Michael Crowle	8 Thomas' Terrace.
Cllr. Jill Green	Tresco, Shrubberies Hill.
Cllr. Jill Menhennet	10 St.Piran's Parc.
Cllr. Godfrey Stephens	8 Penponds Road.
Cllr. Jim Stokes	Trigg Cottage, Loe Bar Road.
Cllr. John Strike	8 Trevenen Bal, Wendron.
Cllr. Katherine Williams	Penvor, 7 Penponds Road.

Councillors Bradbury and Stephens represent us on Kerrier District Council.  
Our County Councillor is Mr. David Richards of Fairlawns, Sunset Drive.

Still on the theme of Rubbish, may we mention General Rubbish Collection? Although the Council does not provide any receptacles for general household waste, it would be more hygienic if dustbins, rather than bags, could be used. If this is not possible, please do not put sacks out before the morning of collection (Monday) to deter seagulls.

**PORHLEVEN REGENERATION PROJECT.**

Work has begun on formulating ideas for a 10-year plan for the good of the village. We should like as much participation from residents (and visitors) as possible. If there is anything you would like to see included (or excluded) from this, please contact one of the Councillors.

**REMEMBER - THIS IS YOUR VILLAGE -**

let's get back the Community Spirit and all work together.

**PORHLEVEN WATER FESTIVAL.**

This will take place on Sunday June 18th. Many events are being planned, with the culmination of the day being the release of dozens of large candle lanterns floated out of the harbour on the evening tide. This Special Event has been arranged in connection with the Year of the Artist, 2000. For further information, contact Geraldine at the Salt Cellar Craft Workshop.

**Wellington Road Bus Shelter.**

*A design is being chosen and it is hoped that the old shelter will be removed very shortly and the new one built*

**RE-CYCLING.** No, this does not mean going for another bike ride, although there are many households in the village still not using the local re-cycling services. Blue bins have been distributed to nearly all residences, not to grow plants in or to store the children's toys, but to fill with empty drinks cans, washed plastic milk bottles, washed food cans, waste paper and bagged old material. These bins are collected by Kerrier Council on alternate Tuesdays. Cardboard will also soon be able to be collected though glass bottles cannot be collected for safety reasons.

However, there is a bottle bank in the car park at Methleigh Botoms. If you have a large amount of re-cyclable waste, why not take it to the re-cycling centre, near Flambards, on your way to your next trip to Tesco? It is not a fallacy that Cornwall is very quickly running out of room for the vast amount of waste we produce, so it is imperative that we re-cycle everything possible.

# Lanterns shed light onto revived festival

CROWDS of people lined the harbour at Porthleven as 200 floating lanterns drifted out to sea in a spectacular finale to a water gala staged in the fishing port on Sunday.

The paper and willow lanterns, made by local schoolchildren under the guidance of Porthleven basketmaker and artist Geraldine Jones, created a magical scene as they were set adrift.

Funded by a grant from South West Arts as part of *Year of the Artist* activities, the

lantern project developed into a full-scale water gala intended to revive week-long carnival celebrations which died out in the port around 20 years ago.

Footage of a carnival held back in 1958 was played during the gala, which began with a drum band parading around a harbour lined with stalls and sideshows.

Trapeze artists suspended from a crane over the gap between inner and outer harbours recreated the myth of the fisherman and the mermaid.

Boats also formed a floating parade, with each vessel, and its crew, representing a different country.

Porthleven harbourmaster Ken Milburn, who helped organise the event, said: "The whole day was a huge success. Right from the word go people were put in a carnival mood and it lasted throughout the evening."

"This wasn't really a money-making exercise. It was something for the whole community to get involved in, and in the end people of all ages helped make it a success."

Mr Milburn said the lantern project may not be repeated, but it was likely a themed water festival would be held again in the port next year.



□ Master of ceremonies Robyn Olliff with nine-foot-tall Luci Dalziel



□ The samba band proceeds through the village



□ The boats leaving the inner harbour

JUNE 2000.





**HESP'S HARBOURS:** Porthleven occupies the head of a narrow inlet between Breage and Sithney. **MARTIN HESP** delves into a Port of Refuge

# A place made for boats, trade and raging seas

**T**HERE'S a famous photograph of the Bickford-Smith Institute and its gaunt clock tower surrounded by wild seas. In a way, the picture is an icon that illustrates man's mad desire to be by the sea, regardless of what the elements may chuck at him. He will sail, surf and swim, he will fish and frolic on the beach – he will even build a special place in which to read; just as long as he can be beside the sea.

Anyone who has ever been to Porthleven will know the Bickford-Smith Institute because its dark, rather austere old reading rooms dominate the harbour mouth. The adjoining 70-foot clock tower watches over the town and lords it over the occasional tempest – just as Big Ben watches over the Thames and stands aloft from the boiling cauldron of Westminster.

Stark and indomitable, the tower seems to say to the ocean, Look, you have your mysteries of the deep and your terrible violence, we have intelligence and books.

Man meets sea. And when he does he must build – not only literary institutes, but groynes and quays, piers and wharves so that he can protect his frail vessels from the mayhem of the waves.

At Porthleven that mayhem is kept firmly outside the Baulk, the narrow mouth of the inner harbour where massive beams of timber are lowered to take the punch out of the waves that come hurtling past the pier, past the institute and into the outer basin whenever there's a sou'westerly howling in across Mount's Bay.

It's an odd name, the Baulk. Being in a reading-room frame of mind, I looked up the word in a dictionary and it said: "A hindrance, a check; a disappointment."

Disappointing indeed if you get home in a storm and find that the harbour staff have used the derrick on the quay to lower each beam into its special place. They're not meant to, and don't without contacting each of the port's vessels, because

this is an official Port of Refuge, according to an Act of Parliament in 1860. At least that's what a local skipper told me, and he seemed proud of this curious old-fashioned status.

But disappointment can also rear its ugly head when massive waves pick up the big beams and throw them about like matchsticks. I talked to some Porthleven men who were congregated by the harbourmaster's shed and all of them had seen the Baulk come unseated in a gale.

"It takes a special sort of wave from a particular direction," said John Russell, who works at the harbour. "And it has to be big..."

Gigantic, I would have thought. The pieces of timber employed to create the

**'I try to have a word with each crew before they go out, to see whether they intend coming back'**

Baulk are between 28 and 32 feet long and two feet thick. Each one weighs two tons, but John and the other men had seen the beams plucked from their settings like bits of cork.

Later, harbourmaster Ken Milburn explained to me that the timbers weren't designed to be an impenetrable dam, but float in their seatings and act as a calming influence on the big "runs" that come into the harbour in gale force conditions.

"It doesn't even have to be gale force," said Ken. "If you get a south-easterly swell in certain tide conditions, you can get a run occurring in here big enough to damage things. Anyway, when they were tightening belts in wartime, they narrowed the channel at the bottom so they could use up some damaged pieces of

timber and this narrowing had the effect of allowing the beams to float more. But they don't come out often – I can only remember it happening two or three times."

"I'll tell you one thing," laughed Jim Allen, who has lived in Porthleven all his life. "The timber's a lot better than the steel gates we had about 25 years ago. They only lasted two tides and were so bent and damaged they had to be cut out."

Porthleven's problem is that the narrow, natural inlet faces south west, straight into the eye of the worst weather you can get roaring across Mount's Bay. A pier points nobly out to sea on the southerly side of the harbour mouth, but it can do little to prevent the waves from entering the outer sections of the port and building up into what Mr Milburn calls a run.

Just past the institute, the natural contours of the valley curve slightly to the north, and this is where the outer harbour, with its own small outer quay, offers the first stages of protection.

The community to the north of the inlet is called Breageside, and it is here, near the Ship Inn, that a second quay forms the inner harbour where the boats are moored. You'll see the baulks of timber and the derrick on this quay, waiting for the weatherman to use the words south-westerly in conjunction with the term gale force.

Just inside this quay are the fishing boats and it was here that I met skipper Robert Williams, of the Girl Penny, who had just been out, in what I thought was a horrible chop, to reap the harvest of his pots. He was kind enough to do us a good deal on a fiver's worth of crabs, but alas we were far too poor even to ask the value of the splendid 8lb lobster which he proudly hauled ashore.

"I remember the days when we could catch 100 of these in the 150 pots which we would put out," shrugged Robert, looking down at his haul of about a dozen



● **LANDMARK:** Stark and indomitable, the dock tower of the Bickford-Smith Institute

lobsters. "But a lot of them were really crayfish and we don't seem to get them any more."

I told him that I didn't envy him his work on a day when you could hear the surf booming at the harbour mouth. "I'd be sick as a dog," I cringed.

"I get seasick, suffered from it all my life," laughed the skipper. "Sometimes it's worse than others. If the crew behave though, it doesn't tend to be so bad..."

What about being caught out at sea when the weather's brewed up rough? "You can go to Newlyn, but the harbourmaster here will always radio to ask you if you're coming back or not. He's got to because it's a Harbour of Refuge according to the Act of 1860."

I asked Ken Milburn about the shutting of the Baulk. "You usually get plenty of warning of gales and I try to have a word with each crew before they go out to see if they intend coming back," he replied. "Then, if things get worse, we'll radio each boat. If they say they're coming back, we'll wait until they do."

None of this was necessary back in the 14th century when Breage on one side, and Sithney on the other, were tiny fishing hamlets surrounding a stream flowing into a small cove. A bar of shingle created the only protection for the tiny boats that worked out of here back then.

Work on a proper harbour began in 1811 because of the increasing need for coal and supplies for local mines. It was a good time to start: soon there were plenty of prisoners from the Napoleonic wars to do the donkey work. But even with their help, the development took 14 years to complete and was eventually opened in August, 1825, with a feast of roast beef and plum pudding.

Thirty years later, Harvey & Co, of Hayle, leased the harbour and built the inner basin so that trade could increase with imports of coal, limestone and timber, and exports of tin, copper and china

## DO'S AND DON'TS

**DO say to a local:** "Where can I get some good fish and chips?" A good chip shop is a rarity nowadays, but Porthleven has a great one – Chips With Everything, in Shute Lane, where "everything" gets fried in fresh palm oil for a lighter taste.

**Don't say:** "Dash." The Dash was a Porthleven lifeboat last used in service during the 1920s. Now she's a rapidly deteriorating hulk in a car park wearing the sad air of the sinkable, and some locals are a little ashamed of her demise.

clay. From that time, Porthleven became well known as a shipbuilding port. Clippers, schooners and yachts were built in the big flat yard just behind the inner harbour in a trade that survived until the late 1970s.

Much of the local fishing fleet, which crowded the harbour 120 years ago, must have been built just a few feet away. No fewer than 144 boats worked out of here in 1880 with a total crew of 583 men and boys. Hundreds of women and children were paid threepence an hour to salt and pack the large catches of pilchards which were processed along the harbourside, and added to these were the craftsmen making sails, nets and ropes for the fleet.

So, thank goodness for William Bickford-Smith, of Trevarno, who, in 1883, spent a large sum on finding them all something to do with their spare time rather than drain the contents of bottles.

He built his Literary Institute so they could go down to the sea and have a thumping good read regardless of the tempest that would occasionally rattle the Baulk in this most pleasant of ports.



● **EXPOSED:** Porthleven takes the brunt of south-westerlies from Mount's Bay



● **LANDMARK:** Stark and indomitable, the clock tower of the Bickford-Smith Institute dominates the harbour mouth at Porthleven

lobsters. "But a lot of them were really crayfish and we don't seem to get them any more."

I told him that I didn't envy him his work on a day when you could hear the surf booming at the harbour mouth. "I'd be sick as a dog," I cringed.

"I get seasick, suffered from it all my life," laughed the skipper. "Sometimes it's worse than others. If the crew behave though, it doesn't tend to be so bad..."

What about being caught out at sea when the weather's brewed up rough? "You can go to Newlyn, but the harbourmaster here will always radio to ask you if you're coming back or not. He's got to because it's a Harbour of Refuge according to the Act of 1860."

I asked Ken Milburn about the shutting of the Baulk. "You usually get plenty of warning of gales and I try to have a word with each crew before they go out to see if they intend coming back," he replied. "Then, if things get worse, we'll radio each boat. If they say they're coming back, we'll wait until they do."

None of this was necessary back in the 14th century when Breage on one side, and Sithney on the other, were tiny fishing hamlets surrounding a stream flowing into a small cove. A bar of shingle created the only protection for the tiny boats that worked out of here back then.

Work on a proper harbour began in 1811 because of the increasing need for coal and supplies for local mines. It was a good time to start: soon there were plenty of prisoners from the Napoleonic wars to do the donkey work. But even with their help, the development took 14 years to complete and was eventually opened in August, 1825, with a feast of roast beef and plum pudding.

Thirty years later, Harvey & Co, of Hayle, leased the harbour and built the inner basin so that trade could increase with imports of coal, limestone and timber, and exports of tin, copper and china

**DO'S AND DON'TS**

**DO say to a local:** "Where can I get some good fish and chips?" A good chip shop is a rarity nowadays, but Porthleven has a great one - Chips With Everything, in Shute Lane, where "everything" gets fried in fresh palm oil for a lighter taste.

**Don't say:** "Dash." The Dash was a Porthleven lifeboat last used in service during the 1920s. Now she's a rapidly deteriorating hulk in a car park wearing the sad air of the sinkable, and some locals are a little ashamed of her demise.

clay. From that time, Porthleven became well known as a shipbuilding port. Clippers, schooners and yachts were built in the big flat yard just behind the inner harbour in a trade that survived until the late 1970s.

Much of the local fishing fleet, which crowded the harbour 120 years ago, must have been built just a few feet away. No fewer than 144 boats worked out of here in 1880 with a total crew of 583 men and boys. Hundreds of women and children were paid threepence an hour to salt and pack the large catches of pilchards which were processed along the harbourside, and added to these were the craftsmen making sails, nets and ropes for the fleet.

So, thank goodness for William Bickford-Smith, of Trevarno, who, in 1883, spent a large sum on finding them all something to do with their spare time rather than drain the contents of bottles.

He built his Literary Institute so they could go down to the sea and have a thumping good read regardless of the tempest that would occasionally rattle the Baulk in this most pleasant of ports.



● **REFUGE:** Fishing boats snuggle up in the inner harbour

JUNE  
2000

# Old newspaper carries report of heroic rescue

A REPORT of an outing to Praa Sands for inmates of the Helston Poor Law Institution is just one of the gems featured in the July 1936 edition of the Marazion and Porthleven Advertiser.

Discovered in a cupboard at the Helston home of Methodist lay preacher Ray Wearne, pictured right, the paper, which cost just one penny, makes fascinating reading.

Among the stories is one headlined "Thrilling Rescue of Breage Man near Porthleven" which tells how Mr Thomas Dudley was plucked from Trewavas Cliffs through the efforts of Constable Pearce and coastguards.

The paper recounts the heroics of the constable who climbed down the cliff to reach the trapped Mr Dudley and then signalled with a lamp to Mr G H Box, who was in charge of the life-saving equipment.

On a lighter note, there is a report of the election of the carnival queen at Porthleven - a ballot won by Miss Gwen Box ahead of Misses Stella Eddy, Kathleen Williams, Sylvia Hosking and Marlborough Orchard.

A decision to tarmac the Porthleven Harbour Road at a cost of £750 is also reported - the county council agreeing to foot the majority of the bill, with the remainder paid by Helston Borough Council and the Porthleven Harbour and Dock Company.

Prices from Helston Market make interesting reading, with Mr Jose Collins selling 103 fat cattle at a price of up to 42 shillings, Mr H E Michell selling 400 pigs and Mr John Collins 650 poultry.

Although more than 60 years have passed since the paper's publication, some items would be no



less relevant among today's pages. The report of a meeting of Kerrier Rural District Council, as it was known until 1974, includes a discussion about litter left at Praa Sands.

Hearing from the clerk there was nothing in the county's by-laws under which action could be taken, a Mr W E Rowe said the only thing to do was "to educate the rising generation in habits of neatness."

Later in the meeting, a proposal by one member that councillors not be provided with lunch when engaged in committee work met with short shrift.



□ Bandsmen Mark Benney and James Watkins enjoy an ice cream

## St Peterstide party well supported

THE traditional St Peterstide celebrations took place in Porthleven at the weekend and there was no shortage of support.

The festival, which involved the the town band

with their new musical director saw many people enjoying themselves in the summer sunshine.

A host of fund and games were organised for visitors.



□ Emma Bassett takes a turn in one of the ball games

### Porthleven

#### Summer show

The annual summer show will be held in the public hall on August 2 at 2.30pm by Mr Ted Gundry - admission 30p, detailed schedules available from the Post Office or William's Newsagents, Fore Street. It would be appreciated if all completed entry forms with entrance fees could be sent to Mrs S Mugford, Springfield, Sunset Drive, or Mrs J Smale, 6 Mill Close, by no later than July 26.

#### Fellowship

The Porthleven Methodist Church Ladies Fellowship held their last meeting in the present session when all the members took part with readings and musical items. Mrs A A Vincent presided and was also the afternoon's accompanist. She announced that the meetings will resume in September. Refreshments were served at the close.

#### Coffee morning

The recent tea/coffee morning held at the home of Mrs Joan Ford of Porthleven, raised £48 for the local ARC. The raffle winners were - Mrs Y Bellinger, Mrs J Ford, Mrs N Quine, Mrs M Wright, Mrs T Semark, Mrs J Tilsley, Mrs M Steer and Rev John Gilbert.

JUNE

JUNE

## Anniversary: Airline invites Porthleven couple to golden celebration

A PORTHLEVEN couple were invited to join in the recent 50th anniversary celebrations of international airline Gulf Air in Bahrain.

Jimmy Stokes was one of the original De Havilland Dove pilots and his wife, Joy, designed Gulf Air's first and third cabin crew uniforms.

The couple were among VIP guests as Gulf Air hosted a ceremony at the Bahrain International Airport to celebrate its history and launched a new logo to commemorate its golden jubilee.

Mrs Stokes, who lived in Bahrain with her husband for nearly 20 years, said the first uniform was designed in 1966 and featured a dress with matching jacket and small peaked beret.

She said: "Circumstances put Gulf Air way ahead of the times. Suitable material was difficult to obtain so a compromise was made and the uniforms were produced in pink, blue, green and purple."

Mrs Stokes, who also designed costumes and scenery for theatrical productions, said she was honoured to be asked to design uniforms on two separate occasions.

"I enjoyed creating a special look for each ensemble and helping to



● Jimmy and Joy Stokes pose at Bahrain airport with air hostesses wearing a variety of costumes from the past 20 years.

shape part of Gulf Air's image."

For Mr Stokes, a Porthleven town councillor, the arrival of two historic aircraft in Bahrain, which retraced Gulf Air's earliest flights from England, was a highlight of the celebrations.

The seven-seater Andon, Gulf Air's first aircraft type and a 1950 eight-seater De Havilland Dove, the airline's second aircraft type,

flew from Coventry and took nearly 14 days to reach Bahrain.

Mr Stokes, who was at the airport to welcome the aircraft, remembers having to change the occasional flat tyre when he flew a De Havilland Dove for the airline in the 1950s.

"There were no auto-pilots at that time and, if need be, you had to change the tyres, too. So you can

imagine how much the aviation industry has changed throughout the years."

He said that the flights from the UK to Bahrain in the 1950s took an average of about four days with stopovers in France and Lebanon. "You needed to stop for re-fuelling and, in the beginning, flights to this area were usually delivery flights which then gradually became passenger flights," he said.

# Dad delivers baby Jordan

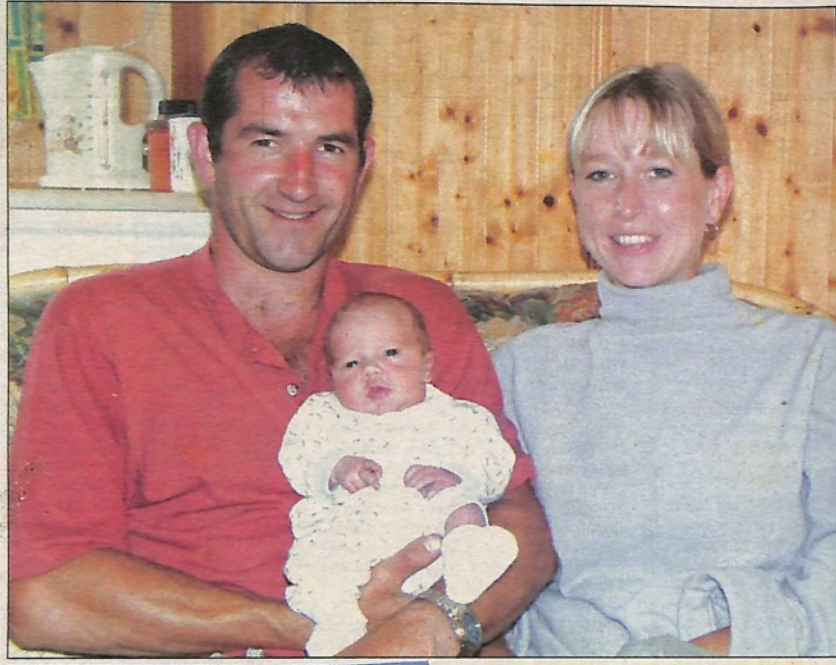

By Tamsin Curnow

A PORTHLEVEN man found himself acting as midwife and delivering a child while hanging on to the end of a telephone and receiving instructions from switchboard operators at ambulance control in Tiverton.

Little Jordan Greet may have been five days late, but his dramatic birth surprised his parents as he decided it was time he arrived into the world only 15 minutes after his mum, Louise, started contractions.

With no time to wait for a midwife Jordan was delivered at the family home in Gibson Way, Porthleven, by his dad Mark.

The birth was all the more unusual because Jordan was born in his foetal sac and, alarmingly, with the umbilical cord wrapped around his neck. He was not breathing, and Mark had to act quickly to break the sac and untangle the cord so the little boy could take his first breath.

Self-employed carpenter Mark told the *Packet*: "I picked him up, rubbed him and tapped his back, and he started breathing. It was an incredible, emotional moment for both of us. He is perfect."

The couple said Jordan was already five days late when the drama began on June 27.

"Jamie woke me up at about 4am, and as I put him back into bed I got my first contraction," said Louise.

"I had two more almost immediately, and I woke Mark up and told him. We were a bit confused because my waters had not broken, but that was explained when he was born still in the sac."

Mark immediately began telephoning their families to let them know, and then called the midwife and the hospital to say they would be coming in.

But Louise quickly realised she was not going to make it to the hospital in time. "I had a fifth contraction, a really fast one, and then suddenly the baby's head was there. I just shouted to Mark he would have to help."

## Stunned

A stunned Mark realised he would have to take over the role of midwife. He dialled 999, and ambulance control said they would have to send an ambulance from Penzance because no vehicles remain in Helston after 2am.

"There was never going to be time for them to get here, so as I delivered the baby I had the phone clamped to my ear listening to instructions from the telephone operator at ambulance control.

"When Jordan was born and he was OK, we could hear everyone at ambulance control cheering. It was a brilliant moment.

"I admit it was a bit of a panic for me, but it was so quick I didn't have time to think about what was happening. I just had to get on with it."

Mother and baby were taken to hospital but were released with a clean bill of health 24 hours after the birth.

The couple have been together for nine years, and have two other sons, Daniel, six, and Jamie, three."

Ironically, Louise had wanted a home birth for her third son, but Mark had persuaded her to go into hospital because "I was not sure about it, and wanted to make sure everything would be alright."

"We had already decided this was going to be our last child, so it's incredible how special he turned out to be."

Louise's father, Mervyn Groombridge, said the whole family was amazed at how quickly Jordan, who weighed in at seven pounds, four-and-a-half ounces, had been born.

"My wife Wyn and I said we would come straight over, and we were there by 4.15am. As we walked up to the house, Wyn said she thought she could hear a baby crying, and I told her it couldn't be. But then we both listened and sure enough we could hear it."

Mark said he would always be grateful to the telephone operator at ambulance control, known only to the couple as Jenny, who guided them through the birth.

"I would like to have met her because she was a God-send."

A spokesman from ambulance control said operators received a week's training, and also had a book with instructions in case of emergencies.

"The operator is the start of the treatment process, and can give invaluable support as long as the person on the other end of the telephone stays calm.

"In this case, Jenny followed her training and it all went extremely well. It is a good success."

JUNE

□ Proud parents Louise and Mark with their baby son Jordan

FROM THIS . . .



Andrea Shannon . . . lost an amazing 7st 5lb and now wears size 14 instead of 28

## They can help you to lose weight . . .

ANDREA Shannon is overjoyed at not being overweight, she's lost an amazing 7 stone 5 lbs at a class in Helston.

She first became overweight by comfort eating due to depression, and couldn't explain why she just sat and ate chocolate and more chocolate and more . . .

"I was like a woman possessed. My self esteem plummeted as my weight rocketed.

"After a much-needed holiday I came home feeling so low. I was embarrassed on the aeroplane, the tray wouldn't fit over my lap, just rested on my stomach - I was appalled.

"I joined Slimming World and have never looked back. The class was so warm and friendly, no humiliation whatsoever. I wondered why I had not done this sooner. To start with I didn't want to know what I weighed, but I was wearing size 28 clothes.

"The eating plan was so generous, I just kept eating and eating and amazingly my weight started to come off. I could still have chocolate and still lose weight.

"The whole family could eat the same so there was no separate meals for myself.

"The day I reached my target weight was so overwhelming, the whole class clapped and cheered, the support from my new friends had been a total inspiration and made all the difference. I could not have done it without them.

"We have a new puppy now and I love taking him for walks. Someone stopped me and asked if I was new in town. She didn't recognise me 7½ stone lighter and a trim size 14."

If you are reading this and think, well it's ok for her but my advice is to go along to a class. Everyone will make you welcome, see what goes on and how the magic is weaved. The consultant will take you through the eating plans. If at the end of the class it is not for you, all you do is walk away and it has cost you nothing.

If you decide to join you can watch the new shape you want start to appear.

Give it a go, it's never too late to start, the eating plan will work for everyone with no exceptions. What have you got to lose?

TO THIS . . .



□ Lowenna Christophers (piano) and flautists Tamsin Christophers, Claire-Louise Auguste and Michael Lugg

## Porthleven

### Wives Club

Members of the Porthleven Wives Club will be holding a cake stall on the Harbour Head on Thursday, August 10 from 10am. All proceeds for the Christian Organisation - The Royal National Mission to Deep Sea Fishermen.

### RSPCA stall

Members of the Porthleven Auxiliary of the RSPCA held a summer stall on the Harbour Head and raised a further £221.50 for their fund, which supports the RSPCA re-homing centre, near St Columb.

### Concert

A concert was given in St Bartholomew's Church, Porthleven and raised £185.60 for the local ARC. Those taking part were the Liskeard Ladies Choir under its musical director, and guest accompanist Sarah Scott. They were joined by the Praze Male Voice Choir under their conductor Mr Len Harvey, and accompanist Marion James. The chair was taken by Chris Goninan of St Just and thanks were extended by Mr Phillip Smith on behalf of the Porthleven branch of the ARC. The evening concluded with a supper served by the ladies' committee.

### Age Concern

Age Concern Porthleven recently held its AGM in the public hall which was well attended. Officers were all re-elected - chairman, Mrs Sheila Richards; treasurer, Mrs May Davies; secretary, Mrs Nancy Reynolds; social secretary, Mrs Pam Eastwell (to ease the workload of the secretary); Mr Brian Berry was invited and agreed to be the official fund raiser, and Mrs Pat Collings agreed to stand in for the treasurer when she goes on holiday.

Mrs Richards thanked everyone for their loyal support with special mention of the minibus drivers and their helpers, and all tea hostesses. This was followed a few days later with a very successful summer fayre which raised £500 for their funds. Last week, they enjoyed their summer outing to Ilfracombe in beautiful weather with the majority of the members plus various friends.

Now they are looking forward to the arrival of the new minibus, which they hope will bring much happiness to all members and any pensioners who wish to use it.

## Porthleven

### Coffee morning

A coffee morning was held in the Porthleven Public Hall on Saturday morning in aid of the public hall refurbishment fund. During the morning a clock, made by a local firm, The Cober Valley Glass Studios, was given to the hall by the local Wives Club, and presented by Mrs Estelle Kitts, the club chairman. It was received by Mrs Brenda Bravery, the chairman of the public hall refurbishment committee.

### Garden party

A garden party for the local RSPCA will be held on Thursday, July 27 from 2-4pm at the home of Mr and Mrs B Howes, Linton, Mill Lane, Porthleven. There will be the usual stall, raffle and refreshments served throughout. Support will be very much appreciated.

### Ladies Circle

Members of the Porthleven Ladies Circle visited the Myrtle Nurseries, Manaccan, where they were welcomed by Mr Barry Hunt who described the various plants they have for sale. Mr and Mrs Hunt later served a buffet supper which was thoroughly enjoyed by all. The next event for the Ladies Circle is a coach trip to Fowey and the Eden Project on Wednesday, August 9 leaving the square at 9am. Anyone wishing to join them are welcome to book through Miss Phyllis Arthur.

### WI meeting

To many of us, the preservation of wildlife is a subject dear to our hearts, and Mr T Geater gave a most informative talk, with the aid of slides, at the Porthleven WI meeting, which was chaired by Mrs Ruth Mynheer. He emphasised the importance of attracting birds, and other creatures such as butterflies, spiders, hedgehogs and legless lizards, all good for the garden. A vote of thanks was given by Mrs Ruth Mynheer.

Mrs Mynheer said a big thank you to Mrs Joy Stokes, vice president, for hosting a strawberries and ice cream after-



□ The Porthleven Line Dancers with Ferdi the Fox of Flambards

AUGUST 2000

## Porthleven couple celebrate golden wedding



**A PORTHLEVEN** couple who met at the village's first ever Gala Week in 1946 celebrated 50 years of marriage on Monday.

Pat Seymour was camping at a farm on Breageside with his Somerset-based church youth club when he met local girl Marjorie Matthews during the Gala Week in August.

Four years later, the couple were married at Peverell Road Methodist Church by the Rev W Luke and went to live in Somerset, where Pat worked as a carpenter and joiner.

Returning to Porthleven in 1956, Pat worked initially for Helston borough council and later for Kerrier district council - a position he retained until retiring through ill health in 1981.

Marjorie, who had worked at a net factory in the fishing village on leaving school, took a job at another net works - Henry Cows and Sons - and stayed there until she retired.

A member of Porthleven Town Band for more than 27 years, Pat is still a keen supporter.

His wife is a skilled needlewoman and enjoys knitting and tapestry.

The couple have two children - Paul, who lives in Devon, and Mary, who lives in Porthleven - and four grandchildren.

Marjorie said: "We've had our ups and downs like everyone else. Give and take is what makes a happy marriage - that, and being there for each other in sickness, as well as in health."

LEFT: Marjorie and Pat with one of their many cards of congratulations

## Football

# Port face testing opening fixture at Millbrook



□ Porthleven Football Club will have a new sponsor for the coming season with St Keverne Bakery fulfilling the role. Pictured above, club chairman Leonard Williams is presented with one of the shirts by Mrs Heather Gilbert of St Keverne Bakery flanked by manager Alan Carey (right) and assistant secretary Jan Coulls

It might still be summer - not that anyone would have noticed - but if there is anything guaranteed to ensure a swift return of hot weather it's the start of the domestic soccer season.

At Gala Parc manager Alan Carey has had his work cut out in rebuilding his side, but he's managed to bring in the players he wants and is now waiting to see how they will gel in the Jewson SWL.

The answer won't be long in coming because on Saturday the Fishermen travel to the border to play Millbrook, one of the sides fancied to be among the SWL front runners.

"We've got a lot of new faces as well some of the more established players, so I think it is going to be a different season for us," said Carey.

"We have retained John Burrows, Dave Larsen, and Adrian Bleasdale, so that is a good backbone, and we have also signed Chris Long.

"I've brought in Ryan Daley, a good left-sided player, and former Exeter City YTS player Nick Medlin.

"There's the Wadebridge trio of Ben Hayden, Richard Triggs, and Adrian Hart and we have also signed David Phillips, a Porthleven boy, who is looking very good. Another young-

By Leon Prynn

ster who I hope will be making his mark is young striker Ian Hodges who has joined from Helston.

"Alan Roberts is in light training and the word is that he could be back in four or five weeks, so that could be a real bonus, but as far as Charlie Legg is concerned we won't be looking in that direction until Christmas at the very earliest."

One thing Carey has not had a shortage of is goalkeepers. When Gary Penhaligon was injured last season Andy Avery took his place and did a great job, but a decision had to be reached on who was going to be the number one.

"I've decided to release Andy Avery," said Carey. "It was a very difficult decision to make because I believe I had the best two goalkeepers in the league.

"Andy is an excellent keeper, did well for us, and had an attitude that was very refreshing, but in the end I decided Gary deserved to be shown some loyalty by me because he has stood by us.

"It was not an easy decision, especially when it is about someone you really like, but in fairness to both

players it had to be done with the season ready to get under way."

The opening game at Millbrook is going to be a real test for Porthleven and could well be the benchmark for their season.

"It's a tough opener for us," said Carey "but we are looking forward to it and all the players are upbeat about the season."

"It's not going to be easy to go there and win points, so if we come away with anything I'll be delighted. Probably as the season develops it will be even more difficult for teams who visit Millbrook to pick up points.

"I don't think we will be challenging for the title this season, that will probably be between St Blazey, Saltash and Falmouth, but come next May I think Millbrook won't be too far away.

"The league will be more difficult to win because I think some of the other sides are now closing the gap and that can only be good for the league. It will definitely be a lot tighter.

"I think we will find the season very difficult and we will have to train and work hard to get anything from our games, but we are all looking forward to the challenge."

□ Caitlin Porthleven model Ze

□ Jill Wal home with

# Porthleven Summer Show attracts hundreds of entries from all ages



□ Caitlin Strike, aged five, from Porthleven with her prizewinning model Zebra made from junk

A HIGH number of entries were exhibited in this year's Porthleven Summer Show, held at the village's public hall.

The various sections, ranging from the most popular, home cooking, to photography, attracted 300 entries with another 200 from the local primary school.

The event was opened by well-known radio presenter Ted Gundry, of Porthleven, who was welcomed by show secretary Sybil Mugford.

The atmosphere built as the presentation of the cups and trophies drew near, with Shirley Lee, of Porthleven, taking the trophy for the best exhibit in the show for her decoupage depicting cockerels.

**Cupwinners:** most points in show, S Mugford; most points in fruit and vegetables, RH Abraham; most points handicrafts, J Walker; most points home cooking, S Mugford; most points preserves, B Gales and AS Hicks; most points photography, DA Bryant; most points flowers, J Walker; most points floral art, J Tilsley; most points floral art novice, B Hendy; most points art, A Berry; most points embroidery, J Walker; most points decoupage, S Lee; most points home-made wine, A Winchcombe; best exhibit in show, S Lee.

**Children:** most points 5 to 7yrs, Caitlin Strike; most points 8 to 11yrs, Kirsty Charles; most points 12 to 16yrs, Tegan Boase.

**First prize winners:** fruit and vegetables - M Bernard, S Mugford, RH Abraham, B Gales, Mrs Abraham; handicrafts - G Thomas, J Tilsley, J Walker and J Williams; home cooking - J Tilsley, B Gray, S Mugford, H Smith, O Richards, G Thomas, J Smale, A Berry and A Hosken; preserves - B Gales and AS Hicks; photography - A Berry, J Walker and D Bryant; flowers - J Williams, S Mugford, M Bernard, J Walker and J Richards; pot plant - S Mugford; floral art - J Tilsley, J Walker and B Gray; floral art novice - B Hendy; art - A Berry and J Tilsley; decoupage - J Walker and S Lee; home made wine - A Winchcombe and Y Bellinger; children 5 to 7yrs - Poppy Mills, Caitlin Strike and Chloe Lord; children 8 to 11yrs - Kirsty Charles; children 12 to 16yrs - Tegan Boase.



□ Her cockerel decoupage won Shirley Lee best exhibit in the show



□ Porthleven's Alice Allen, aged five, with her rabbit made of junk



□ Jill Walker from Porthleven went home with three cups



□ Denys Bryant proudly holds up his cup for photography



□ The table is laden with exhibits while the prize winners are announced

AUGUST 2000



□ The wonderful thing about Tiggers - Helston's Tegan Boase, aged 12, with her cross-stitch bookmark



□ Show organisers June Smale and Sybil Mugford displaying some of the many wonderful and colourful blooms entered at the show



# Michael's Bible is 440 years old

A GENEVA Bible dating from 1560 was the eventual winner of a hunt to find the oldest Bible in the area being held in connection with a week-long exhibition at the Christadelphian Hall in Porthleven.

Owned by Michael Wright, of Manaccan, the valuable Geneva edition was saved from a dustcart by his father during the Blitz in London.

Produced by exiled Protestant scholars in Geneva, it is extremely outspoken in places.

Known as a Breeches Bible because Adam and Eve were said to have made themselves breeches, the edition contains numerous handwritten notes in minute writing.

### Story and pictures by Jill Walker

Michael Gale, of Porthleven, claimed second place in the hunt with a 1619 Authorised Version, which his father found bricked up in a cottage he was renovating.

Third prize was awarded to Jean Howard, of Porthleven, for two huge volumes dating from 1789 and 1855.

Among the other entries was a Bible presented to Mr and Mrs W Polglase - the first couple to be married at Helston Methodist Chapel - which was brought in by Phyllis Arthur, of Porthleven.

A steady flow of visitors were fascinated by the wide range of items featured in the National

Bible Exhibition, which was at the hall in Church Row last week.

The main attraction was the collection of Bibles in a variety of languages and from all periods of history, including some of the first editions printed and copies of valuable handwritten volumes.

A large Hebrew scroll was also on display, as was the smallest Bible in the world, which has to be viewed through a magnifying glass.

Coins and stamps connected with the Bible theme and copies of museum exhibits were an unexpected addition to an excellent display.

Stewards and helpers involved with the exhibition attended a barbecue to mark the end of a highly successful week.

□ The prize winners: left to right, back - Michael Gale (second), Jean Howard (third) and Michael Wright (first); in front is Mrs Wright, holding the winning 1560 Geneva Bible

AUGUST 2000

## Porthleven Women's Institute



□ Jean Bryant

To most of us the names "cirro cumulus" - high clouds, "cirro stratus" - middle clouds, or "cumulo nimbus" - lower clouds, mean not a thing. Clouds are studied as to whether our washing is likely to dry, or we need to take our water-proofs and umbrellas when we venture outside.

However, attitudes were changed when Mrs Goodswen gave a most enlightening talk on "The weather and its effect on the landscape", at the Porthleven WI meeting, which was chaired by Mrs Ruth Mynheer, president.

Mrs Goodswen touched on many aspects of the weather - rainbows, moisture attracting slugs and snails, especially in Cornwall, vegetation, gorse fires caused by dry conditions, ice crystals, turrets on clouds producing rain, mares tails blown by the jet stream, mists and cobwebs on the gorse sparkling in the early morning sunlight - all were brought alive and illustrated in great detail by a truly wonderful array of slides taken by her on her travels throughout all parts of Great Britain. Mrs Ruth Mynheer gave a vote of thanks, stating that members, she was sure, would view the skies with a different perspective from now on.

A harvest auction took place during the evening raising funds, and Mrs Mynheer reported on the summer fete, which also raised necessary funds for the WI. She thanked members for their loyal support, and stated that enough money had been raised for members to have a free 75th birthday lunch, which was to be held in the Porthleven Public Hall on September 13 at 12.30 - 1.00pm. She also thanked Mrs Francoise Ziemann for raising funds, and participating in a sponsored swim. A letter of thanks was read out from Oliver Williams, thanking members for his winning in the raffle, two tickets to Flambards, which he thoroughly enjoyed.

Flower of the month: 1, Sybil Mugford; 2, Ruth Mynheer; 3, Jill Walker and J Smale. Competition - Weather - a floral arrangement in a 12" space: 1, Jill Walker; 2, Jill Tilsley; 3, Melique Beach. Birthday posies were presented to M Beach and E Williams. The tea hostess was M Beach.

### St Bartholomew's Church

A coffee morning was held at the home of Miss Pauline Rosewarne of Mill Close, Porthleven, and raised £36.50 for church funds. The raffle winners were: Rev John Gilbert, Rev Alan Horsley, Rev J Walker, Mrs D Walker, Mrs Jean Lloyd, Mrs B Gilbert, Mr Bryan Rosewarne, Mr Noel Snell and Mrs M Hooper.

### RSPSC

Members of the Porthleven Auxiliary of the RSPCA held another summer stall on the Harbour Head and raised a further £323 for their fund.

## Porthleven town council round-up

PLANS to re-landscape the pond in the amenity area would make it safer and more environmentally friendly, councillors said last week.

Moves to improve the area follow a number of incidents in which dogs have fallen into the pond and been unable to climb out because of the sheer sides.

Fears that a child could encounter the same problem, combined with the need to completely clear out the pond, have prompted councillors to take action.

Chairman Dave Blanning said the site would be re-landscaped so that the pond had sloping banks.

Imaginative planting would turn the area into a more natural environment and encourage wildlife.

It was hoped more people would use the newly landscaped area, including groups of schoolchildren undertaking project work.

● The council is due to decide tomorrow which local firm of consultants it will employ to draw up a strategy document for Porthleven which will form the basis of applications for funding under the Objective One programme.

Mr Blanning said public consultation would be an important part of a process which would guide future developments in the village as a whole.

The council has set aside funding for the project, but additional contributions from private individuals and businesses will determine how far-reaching it can be.

It is hoped the document will be completed as soon as possible.

● The council is to seek planning permission for a new bus shelter on Wellington Road.

Members agreed the new shelter would be located by the bus stop, unlike the previous structure which was demolished after being condemned as an eyesore.

A design has been agreed and it is hoped trainees from the youth employment service will carry out the work.

● The council is considering creating floral displays on the Wellington Road and Methleigh Bottoms approaches to the village.



The Dean and Chapter of Truro Cathedral and the Flower Festival Committee



have pleasure in inviting

Pat Adams

to the preview evening of Celebrating Cornwall 2000 in the Cathedral on Thursday 7th September 2000 at 7.00pm. The Festival will be opened by the guest of honour, the Lord Lieutenant of Cornwall,, Lady Mary Holborow

RSVP to:  
Flower Festival Committee  
Truro Cathedral Office  
14 St Mary's Street  
TRURO TR1 2AF

I did an arrangement there for Porthleven Club.



□ Sheila Richards gets the keys from Dales business representative Ivan Tonkin and the rest of the committee Pam Eastwell, Patricia Collings, assistant treasurer, Lilian Pawlyn, Nancy Reynolds, secretary, Violet Grimson and Nancy English. Not pictured May Davis, treasurer

## Brand new mini-bus given to Age Concern

ELDERLY people in Porthleven will be riding in style in the future after a brand new minibus was delivered to the local branch of Age Concern.

Keys to the £30,000 vehicle, which has a tail-lift specially adapted for wheelchairs, were handed over last week during celebrations at the village's public hall.

The arrival of the minibus follows 18 months of fundraising by members of the branch.

Grants were received from Cornwall

county council, Kerrier district council, the Pirate Trust, the Millennium Festival Awards, Porthleven town Council and from Dales Motors, who supplied the 17-seat vehicle.

Donations were also received from St Bartholomew's Church, Porthleven, and the WI.

Porthleven Age Concern chairman Sheila Richards said it had been a real community effort.

"The committee took the lead, but we could not have done it without the sup-

port of our members, and the wider community.

"Our previous bus was 11-years-old, and although it has only broken down once in all that time, the bodywork was beginning to let us down badly.

"We use the bus most days and the new one will be a real bonus."

Many of the branch's 70 members joined in the celebrations at the hall last Thursday, which saw the new vehicle dedicated by Porthleven's Methodist minister the Rev Robert Ormesher.



## Porthleven celebrates its 25th Lifeboat Day

THIS year marks the 25th lifeboat day at Porthleven since its inauguration in 1976.

It was founded by Stan Lloyd and a group of fishermen led by Herbie Uren when they decided to raise funds for this worthwhile cause by creating a day when everyone could become involved and enjoy themselves. Up to 1998 £64,000 had been raised - this does include a sum of legacies left to the RNLI through the Porthleven and District Branch. Last year about £5,000 was raised. Since 1995 when the branch was formed other sums have also been raised through various events held throughout the year.

Porthleven did at one time have its own lifeboat. From 1863 until 1929 four lifeboats served at the station; all were powered by oars and it was a most difficult station to launch from. In 1929 it was decided that the motorised lifeboats stationed at the Lizard and Penlee would provide a better service and Porthleven's last lifeboat, *Dash*, was stood down.

The RNLI are well supported by the local business community and this year have the added sponsorship of an oil company. Over the years a tradition of "pirates" has been established and more recently children from Porthleven School have joined in this tradition and helped to do some of the collecting of visitors' small change.

This year Lifeboat Day is on Sunday August 27 and events begin at 10am - until 1.30pm all are land-based. Then begin the waterborne events. The individual times of these events are published in the programme. The events include "Dash II" being launched and running down the slipway for as long as the tide allow - a great favourite with the children, the Bath Tub novelty race, Hayle Canoe Club demonstration, the Working Boat race, Tight Wire bike stunt, lifeboat manoeuvres in the outer harbour and of course the helicopter and lifeboat rescue exercise.

The land-based events include the RNLI souvenir stall, cake stall, bric-a-brac stall (this year much bigger), amusements, bouncy castle, donkey rides, Pearly King and Queen, face painting, face sketches and the Lifeboat Day draw.

The events all take place in or around the harbour which is a very popular venue. So why not pop along and support this wonderful day?

**Lots of fun for all the family**

### PORTHLEVEN PUBLIC HALL MANAGEMENT COMMITTEE

(Registered Charity No. 261124)

*Request the pleasure of the Company of  
Representative Porthleven Floral Club*

*at the Re-opening of the  
Public Hall and Women's Institute  
by the Chairman of Kerrier District Council,  
Councillor Mrs. Wendy Lawrence,  
on Saturday, October 21st at 3 p.m.*

R.S.V.P. to Mrs. Joy Gunter,  
Chy Lowenna, Loe Bar Road, Porthleven, TR13 9EL  
(by the 30th September, 2000)



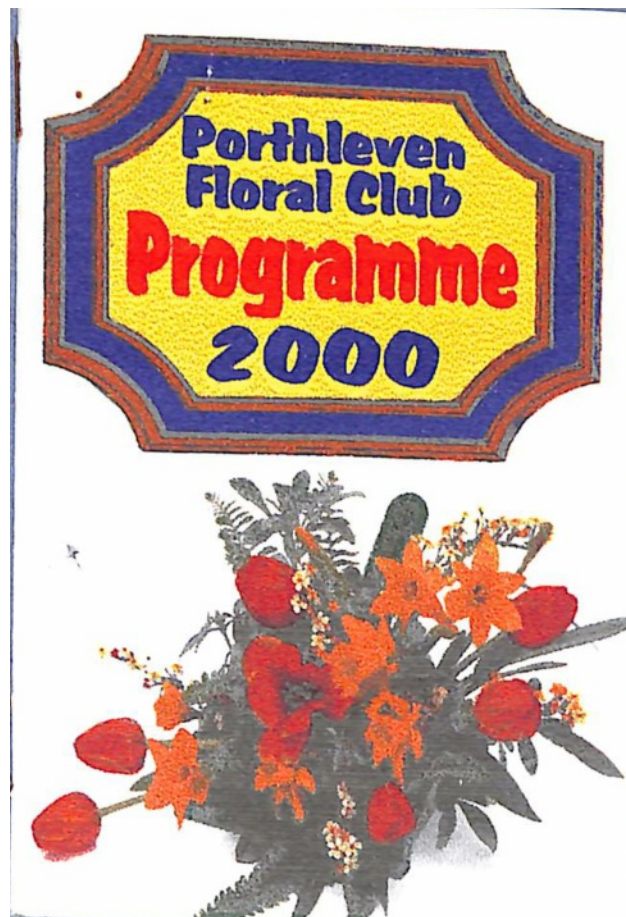

### Meetings

Meetings are held on the fourth Wednesday of the month, unless otherwise stated, in the Public Hall, Porthleven.  
7pm for 7.15pm

Committee Meetings are held on the third Monday of each month at 7.30pm

### Porthleven Floral Club

#### OFFICERS 2000

**President:** Mrs J Osborne  
Tel: 01326 564050

**Vice President:** Mrs R Williams  
Tel: 01736 762857

**Chairman:** Mrs PE Lane  
Tel: 01326 562372

**Vice Chairman:** Mrs A Rogers

**Secretary/Minutes Secretary:**

*Mrs Pearce* { Mrs L Pearce } *over once again*  
Tel: 01326 574000

**Show Secretary:** Mrs M Liddell  
01326 573525

**Treasurer:** Mrs M Kerbey  
Tel: 01736 762345

**Sales Table:** Mrs D Pawley  
Tel: 01326 561614

(with Mrs R Williams assisting)

**Club Publications:** Mrs L Pearce  
Tel: 01326 574000

#### COMMITTEE

Mrs M Kitchen Tel: 01326 574375

Mrs E Kitts Tel: 01326 562454



### Tea Hostesses

#### February

Elaine Lane and Elinor Williams

#### March

Marjorie Kitchen and Marion Beach

#### April

The Committee

#### May

Ruth Williams and Daphne Pawley

#### June

Jeanette Richards and Jill Tilsley

#### July

Estelle Kitts and Angela Rogers

#### September

Marjorie Kerbey and Josie Osborne

#### October

The Committee

#### November

Marion Liddell and Pat Adams



## Programme 2000

**Wednesday, 26th January**  
Club Dinner  
Venue tba

**Wednesday, 23rd February**  
Area slides: "Barnstaple 1998"  
Competition: "Winter" to fit in an 18inch space. Judging by pennies

**Wednesday, 22nd March**  
"Spring and all that!"  
a demonstration by Mrs J Walters and Mrs I Pryor (Camborne and Redruth)  
Competition: Daffodils! Arrangement to fit within an 18inch space.

5



**Wednesday, 26th April**  
"Memories"  
A demonstration by Robin and Sheila Hadlow (St Austell)  
Competition: "Victoriana" to fit within an 18" space.

**Wednesday, 24th May**  
"Ready, Steady, Arrange"  
a demonstration by Mrs Helen Thomas (Truro)  
Competition: "Darling Buds of May" a petite arrangement 9 inches

**Wednesday, 28th June**  
Plants from Down Under (A gardener's delight)  
Mr SJ Mules (Rosudgeon)  
Competition: All foliage arrangement to fit within an 18inch space.

7



**Wednesday, 26th July**  
Fun with Colour  
a demonstration by Mrs Enid Smith (Rosudgeon)  
Competition: A basket from the garden to fit within an 18" space.

**August**  
No meeting

**Wednesday, 25th September**  
Autumn Exhibition and Show

9



**Wednesday, 25th October**  
Annual Meeting

**Wednesday, 22nd November**  
"Christmas Magic"  
A demonstration by Mr Richard Forster (Torquay)  
Open Meeting)

**December**  
No meeting

# 2000

Bank / Holidays are shown in red  
Floral Club meetings are shown in green

**JANUARY**

Su	Mo	Tu	We	Th	Fr	Sa
						1
2	3	4	5	6	7	8
9	10	11	12	13	14	15
16	17	18	19	20	21	22
23	24	25	26	27	28	29
30	31					

**FEBRUARY**

Su	Mo	Tu	We	Th	Fr	Sa
		1	2	3	4	5
6	7	8	9	10	11	12
13	14	15	16	17	18	19
20	21	22	23	24	25	26
27	28	29				

**JULY**

Su	Mo	Tu	We	Th	Fr	Sa
						1
2	3	4	5	6	7	8
9	10	11	12	13	14	15
16	17	18	19	20	21	22
23	24	25	26	27	28	29
30	31					

**AUGUST**

Su	Mo	Tu	We	Th	Fr	Sa
		1	2	3	4	5
6	7	8	9	10	11	12
13	14	15	16	17	18	19
20	21	22	23	24	25	26
27	28	29	30	31		

**MARCH**

Su	Mo	Tu	We	Th	Fr	Sa
			1	2	3	4
5	6	7	8	9	10	11
12	13	14	15	16	17	18
19	20	21	22	23	24	25
26	27	28	29	30	31	

**APRIL**

Su	Mo	Tu	We	Th	Fr	Sa
						1
2	3	4	5	6	7	8
9	10	11	12	13	14	15
16	17	18	19	20	21	22
23	24	25	26	27	28	29
30						

**SEPTEMBER**

Su	Mo	Tu	We	Th	Fr	Sa
					1	2
3	4	5	6	7	8	9
10	11	12	13	14	15	16
17	18	19	20	21	22	23
24	25	26	27	28	29	30

**OCTOBER**

Su	Mo	Tu	We	Th	Fr	Sa
	1	2	3	4	5	6
7	8	9	10	11	12	13
14	15	16	17	18	19	20
21	22	23	24	25	26	27
28	29	30	31			

**MAY**

Su	Mo	Tu	We	Th	Fr	Sa
	1	2	3	4	5	6
7	8	9	10	11	12	13
14	15	16	17	18	19	20
21	22	23	24	25	26	27
28	29	30	31			

**JUNE**

Su	Mo	Tu	We	Th	Fr	Sa
				1	2	3
4	5	6	7	8	9	10
11	12	13	14	15	16	17
18	19	20	21	22	23	24
25	26	27	28	29	30	

**NOVEMBER**

Su	Mo	Tu	We	Th	Fr	Sa
		1	2	3	4	
5	6	7	8	9	10	11
12	13	14	15	16	17	18
19	20	21	22	23	24	25
26	27	28	29	30		

**DECEMBER**

Su	Mo	Tu	We	Th	Fr	Sa
						1
2	3	4	5	6	7	8
9	10	11	12	13	14	15
16	17	18	19	20	21	22
23	24	25	26	27	28	29
30	31					



□ Jane Williams and Mamie Wright



□ Maggie Higgins and Ann Winchcombe



Joan Williams and John Williams

23 August

# Craftsmanship

Members of church put on splendid display

THE varied talents of members of St Bartholomew's Church, Porthleven, were on display last week in a craft show which formed the centrepiece of a patronal festival held at the church to mark the new millennium.

Painting, needlework, decoupage, woodcarving and china decorating were just a few of the skills represented at the four-day festival.

A fascinating display of church registers and records, archive photographs of Porthleven and a video presentation on the history of the village were also enjoyed by the many local people and visitors who attended.

Cream teas and other refreshments were served throughout the event.



□ Joan Pawlby and Ros Lansdowne

□ David Gill, 1 Queens - help

# Lif

RNLI funds are more than £4,000 successful Porthleven Sunday.

Celebrating its 150th anniversary, the club attracted hundreds of people to enjoy highlights in rescue helicopter Penlee lifeboat *Mal*.

There was also a series of water-based events including *Dash II* and Porthleven Harbour-side event. The club is referred to keep their

Jean Howard, speaker and district branch was still to be established. The amount

"It was a lovely day, maybe not as big as last year, but it seemed to be enjoyed by everyone. It was an important thing."

The tradition of lifeboats when Stan Lloyd and Herbie Uren decided to fund the RNLI.

Since that time, a lot of money has been raised for the charity on lifeboats.

No 1 Date 23/2/00  
 Received from Mrs. P. Adams  
 the sum of Ten Pounds 99/00  
 Subscription  
 Porthleven Floral Club  
 M. Kebley

£10 -

by St. Rev. gave a concert on the head.



David Gill, David Clarke, Gerry and Helen Arrowsmith - Pearly Kings and Queens - helping to raise money for the RNLI



Tegan Shainberg has her face painted by Mandy Auguste

# Lifeboat Day winches in £4,000

RNLI funds are set to be boosted by more than \$4,000 following another successful Porthleven Lifeboat Day on Sunday.

Celebrating its 25th anniversary, the event attracted hundreds of people to the harbour to enjoy highlights including a demonstration by a rescue helicopter from RNAS Culdrose and the Penlee lifeboat *Mabel Alice*.

There was also plenty of support for the other water-based events, including a chance to ride in *Dash II* and Porthleven gig the *Energetic*, and varied harbour-side entertainment for those who preferred to keep their feet on dry land.

Jean Howard, spokeswoman for the Porthleven and district branch of the RNLI, said a final figure was still to be established but the day's proceeds were set to amount to over \$4,000.

"It was a lovely day. There was a good crowd - maybe not as big as some years, but everyone seemed to be enjoying themselves and that's the important thing."

The tradition of lifeboat day began back in 1976, when Stan Lloyd and a group of fishermen led by Herbie Uren decided to stage an event to raise funds for the RNLI.

Since that time, almost \$83,000 has been raised for the charity on lifeboat days.

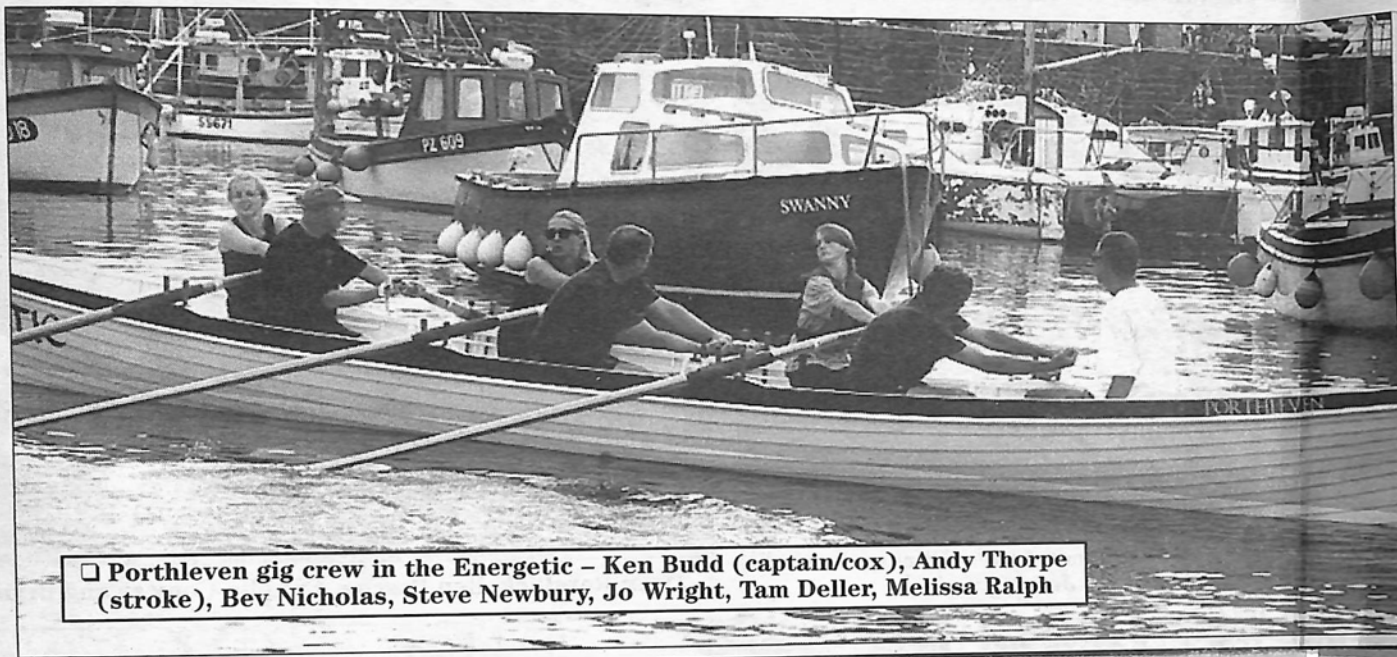

Porthleven gig crew in the *Energetic* - Ken Budd (captain/cox), Andy Thorpe (stroke), Bev Nicholas, Steve Newbury, Jo Wright, Tam Deller, Melissa Ralph



The torchlight procession wends its way through Porthleven

## Torchlight procession is a spectacular sight

The harbourside at Porthleven was a spectacular sight on Monday evening as a record number of people joined in the port's annual torchlight procession.

Hundreds of candles were carried through the village by people of all ages in a procession led by St Keverne Band, which also gave a concert on the harbour head.

Earlier in the evening, a spectacular fireworks display orchestrated by Graham Williams delighted the crowds, and a barbecue and grand draw were also part of the entertainment.

Organised by members of the Porthleven Lymphoedema Support Group, the event raised over \$1,000 for the charity.

Group chairman Kay Moon said she and fellow committee members David Moon and Ann Miners were delighted at the success of the evening.

"We had a record-breaking crowd this year and we were blessed with the weather. Thanks to Graham, and his assistant Dave, the fireworks display was out of this world - the best we have ever had - and everyone seemed to have a brilliant time."

Mrs Moon said special thanks were due to Kevin, Megan and Maureen for their help on the night, to Godfrey Stephens for providing transport and also to businesses in Porthleven for their donations and support.

27 August 2000



PORTHLEVEN  
FLORAL CLUB

CONSTITUTION

28 August



PORTHLEVEN  
FLORAL CLUB

---

**CONSTITUTION**

---

MRS PATRICIA ADAMS  
3 TREMEARNE ROAD  
PORTHLEVEN  
NR HELSTON  
CORNWALL TR13 9BN  
TELEPHONE (0326) 561564

PORTHLEVEN FLORAL CLUB  
**CONSTITUTION**

*Contents*

- 
- 1 Name
  - 2 Aims and objects
  - 3 Membership
  - 4 Officers and Committee
  - 5 Election of Officers and Committee
  - 6 Powers of Officers and Committee
  - 7 Annual General Meeting and  
Special General Meeting
  - 8 Income
  - 9 Dissolution
  - 10 Contingencies

The first Officers - 21 May 1974.  
CHAIRMAN Mrs B. Hagenbach,  
Blue Sea, Lee Bar Road.  
VICE CHAIRMAN Mrs E. Hollands,  
The Gables, Fore Street. (EMD)  
SECRETARY Mrs Jean Greenwood,  
1, Tremearne Rd. Porthleven.  
ASS. SECRETARY  
Mrs Gwen Russell, Unity Road.  
TREASURER  
Mrs Margaret Rosewarne,  
14 Penfords Road.  
SALES TABLE  
Mrs Patricia Adams,  
Salt Spray, Mounts Road.  
PUBLICATIONS OFFICER  
Mrs Beckerley, Sautherly,  
Methley Parc.  
PRESIDENT Mrs Angela Rogan,  
Penrose Estate.  
our and  
for their help on the  
Stephens for

1 Name

The name of the Society shall be "Porthleven Floral Club", herein after referred to as "the Society".

2 Aims and objects

To encourage and promote the art of flower arrangement in all its aspects. To organise Shows, Exhibitions, provide tuition, or any other activities to advance the aims of the Society, and to support charitable causes.

3 Membership

1 Membership shall be open to all those interested in Floral Art and in all its aspects.

2 All members shall pay an annual

subscription which shall be due on the 1st. November each year. The amount of the annual subscription shall be reviewed each year at the AGM.

3 Members are entitled to attend all meetings, lectures, demonstrations etc., and to participate in competitions, exhibitions, and courses of tuition organised by the Society for which fees may be charged.

#### 4 Officers and Committee

1 President, and Vice Presidents. The Society shall honour any member, or in exceptional circumstances, any non-member, by inviting them to be President or Vice-President.

annually for a period not exceeding three years. A Vice-Chairman or Committee member who is elected to the Chair shall be eligible to serve for a further period of three years. The Secretary and Treasurer shall be elected annually. Committee members shall normally be elected for a period of two years and shall be eligible for re-election after a lapse of one year.

3 Any member desiring to nominate any other member for election to the Committee or to any of the Society's offices must first ascertain that the member is willing for the nomination to go forward. No one member may nominate more than two members for the Committee. All nominations must reach the Secretary not later

#### 6 Powers of Officers and Committee

1 Any member may resign from office, in which case the Committee may appoint a member to fill the vacancy so caused and such appointment shall hold good until the next AGM.

2 Any cheque drawn from the Society's funds shall have the signature of the Treasurer and another of the Society's Officers who shall be authorised by the Committee to draw cheques.

3 The committee shall meet as considered necessary and five shall be a quorum.

2 The Officers of the Society shall consist of Chairman, Vice-Chairman, Secretary, Treasurer, Assistant Secretary and Assistant Treasurer.

3 The Committee shall consist of Chairman, Vice Chairman, Secretary, Treasurer, Assistants, and six other members. The Committee shall have the power to co-opt other members as they think fit and necessary.

#### 5 Election of officers and committee

1 The President and Vice-Presidents of the Society shall be nominated by the Committee for election by the members at the AGM. The term of office to be two years.

2 The Chairman and Vice-Chairman of the Society shall be elected

than the 1st October, and all nominations must be seconded. Should nominations exceed the vacancies, ballot papers will be prepared and issued to members at the AGM. If nominations received are not sufficient to fill the vacancies, further nominations may be proposed and seconded at the AGM according to the number of vacancies.

4 The management of the Society shall be entrusted to the Officers and Committee, subject to no restrictions other than those imposed by this constitution or validly carried resolutions of an Annual General Meeting or Special General Meeting.

#### 7 Annual General Meeting and Special General Meeting

1 The AGM of the Society shall be held on the fourth Wednesday in the month of October. To receive the report of the Committee, to consider the accounts and to elect the Officers and Committee for the ensuing year, and for the transaction of other business appropriate for the AGM.

2 The President shall be the Chairman of the meeting and in their absence their place may be taken by:-

- a) Any Vice-President
- b) The Chairman of the Society
- c) A Vice-Chairman

in that order.

3 The Treasurer shall present the accounts for the previous financial

year - ending on the 30th September. Prior to the meeting these accounts shall have been audited by the Society's Auditor. Also an inventory of the Club's stock and properties shall be presented.

4 The Society shall at its AGM appoint an Auditor to the Society for the ensuing year according to the recommendations made by the Committee.

5 Alterations, amendments, or additions to the Constitution shall be made only at the AGM or at a special meeting called for that purpose. Alterations and notice of intention to propose changes must be sent to the Secretary not later than 28 days before an AGM and not later than 21

days prior to a Special meeting. No such changes shall be deemed carried except with the consent of not less than two thirds of the members voting and present. A minimum of ten members shall be present to form a quorum.

#### 8 Income

All income shall be used for the benefit of the Club and no personal profit shall be made by any member from any sales.

#### 9 Dissolution

In the winding up of the Society, the affairs thereof shall be administered by the Chairman, Secretary, and Treasurer and any funds remaining

shall be dispersed according to the wishes of the members attending the winding up meeting.

#### 10 Contingencies

The Committee shall have the power to deal with any matter arising which is not provided for in this Constitution.

The Constitution was adopted at a General Meeting of the Society on 27th April 1977



Club closed October 2000 after 26 years. Mrs Rogers & J. the only 2 founder members left.

Floral Art Classes started 19-2-74 with 37 members.

Opened a Bank Account at Barclays Bank 1 March 1974

Floral Club started 21 May 74 on the Third Tuesday at 2.15pm in the Public Hall.

There was an age limit, for joining of 16 years or over.

Yearly Subscription	£1.50
affiliation fee	20
	£1.70

Visitors 20p.

Mrs Hagen back.

sent us £40 to get going which was spent on goods for the Sales Table.

Founder Members, & still members left 20 years on.

Mrs P. Adams. Mrs B. Bravery  
Mrs J. Pawlby. Mrs G. Russell.  
Mrs A. Rogers.



## The Parish Churches of St. Sithney, Sithney and St. Bartholomew, Porthleven

are in the Church of England which is one of the Churches making up the Anglican Communion and are the parishes which form the United Benefice of Porthleven with Sithney, are in the Deanery of Kerrier, the Archdeaconry of Cornwall, the Diocese of Truro and the Province of Canterbury. They are also twinned with Guissey in Brittany.

Our Bishop is: The Right Reverend William In d B.A.

Our Parish Priest is: The Reverend Peter A.A. Walker,  
The Vicarage, Pendeen Road, Porthleven, TR13 9AL. Tel: 01326 562419

Our Lay Reader is: Mrs. Joy Gunter,  
Chy Lowenna, Loe Bar Road, Porthleven, TR13 9EL. Tel: 01326 573819

Our Churchwardens are:

**SITHNEY**  
Mr. W.G. Rowe,  
Arisaig, 2, Tregunna Close,  
Porthleven. Tel: 01326 572225

Mr. E.C. Mildren,  
Trelean,  
Sithney. Tel: 01326 574032

**PORHLEVEN**  
Mrs. M. Hooper,  
Old School House, 6 Church Row,  
Porthleven. Tel: 01326 562216

Mr. P. Smith,  
Llawncroc, 4 Warren Close,  
Porthleven. Tel: 01326 563875

### REGULAR SUNDAY SERVICES

0800 at Porthleven - The Holy Eucharist - Book of Common Prayer  
1000 at Porthleven - Solemn Mass and Junior Church  
1130 at St. Sithney - Sung Eucharist  
1800 at St. Sithney - Evensong and Sermon

### REGULAR WEEKDAY SERVICES

Tuesday: 0915 - Morning Prayer (1st, 3rd and 5th Tuesdays at St. Bartholomew's,  
2nd and 4th Tuesdays at St. Sithney)  
1900 - The Holy Eucharist at Porthleven  
Wednesday: 1000 - The Holy Eucharist at St. Sithney  
Thursday: 1000 - The Holy Eucharist at Porthleven  
Friday: 0915 - The Holy Eucharist at Porthleven - Book of Common Prayer  
1500 - The Meditation Group meets in St. Elvan's Room, Porthleven

### JUNIOR CHURCH

The children receive instruction in the St Elvan's Room, during the first part of the service and join us at the offertory. They may join their parents and go to the altar for a blessing at the time of Holy Communion.

### CONFESSIONS/COUNSELLING

Father Peter will be at St. Bartholomew's on Thursdays at 11am, or by appointment, for the Sacrament of Penance, also Counselling.

### HOLY BAPTISM/BANNS OF MARRIAGE

Arrangements for these may be made at 7.30pm on Tuesdays at St. Bartholomew's, or by appointment.

### MINISTRY TO THE SICK

Please let Father Walker know immediately of all cases of sickness.

The Blessed Sacrament is reserved in the tabernacle of both Churches and is taken to the sick and dying at any time of the day or night. Holy Oil, blessed by the Bishop in his Cathedral on Maundy Thursday is also available for the Sacrament of Anointing. Father Peter is always happy to have the opportunity to explain the Sacraments and their use to any who are uncertain.

### BURIAL OF THE DEAD

The coffin is normally received into Church before the burial and prayers are said. A Requiem (The Holy Eucharist for the departed) may follow or take place on the day of burial. Please let Father Walker know at once when someone dies. The departed are usually remembered at the Holy Eucharist on the anniversary of their death.

PLEASE NOTE Father Walker's day off is normally SATURDAY. Urgent messages may be left with the Churchwardens.

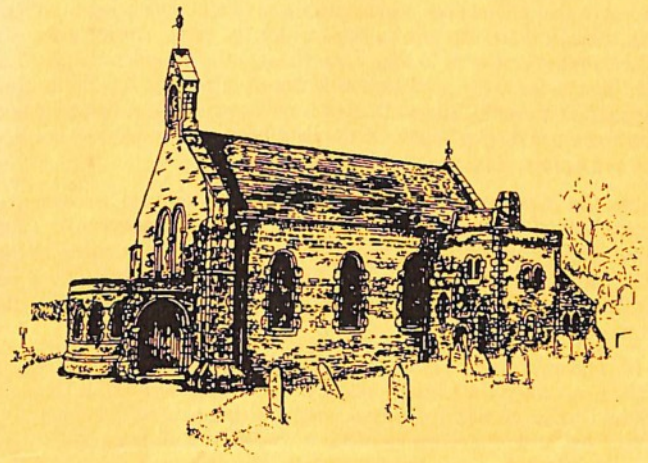

## St Bartholomew's Porthleven

### A walk around the Church

#### A WALK AROUND ST. BARTHOLOMEW'S CHURCH

We enter the Church by the south door, which has a rounded Norman style arch and leads into the Baptistry.

Here is the great granite font dating from 1842. It is some 3 feet square and 18 inches deep, set on four pillars upon a squared granite plinth, thus being about four feet high overall. Behind it are two granite steps which the priest mounts when performing a baptism, so that he stands looking down through the Church to the High Altar, while behind him is the seven-light window in the rounded west wall of the Baptistry, and the great Easter candle. The north door is no longer in use, it being hidden from view by the notice and display board. On the right-hand wall by the door is a stoep for holy water, and a prayer desk and chair are also provided.

Between the Baptistry and the main body of the Church is a screen, consisting of double doors of light oak with glass panels and a semi-circular fanlight above continuing the rounded arch design that predominates in so much of the Church's interior. Engraved on the central glass panel above the doors is a dove of peace, one of many beautiful additions that have been made to this building over the years in memory of loved ones.

The tiled flooring of the Baptistry is repeated down the central aisle, along which we proceed to approach the Chancel. Above it is the Hanging Rood, in the form of a huge polished wooden anchor. Its central portion is the basis of a crucifix, while on the points of the anchor are figures of Mary, the Mother of Jesus, and of St John, the beloved disciple, keeping faithful vigil beside Our Lord on the Cross. It is an impressive piece of craftsmanship that has graced this building for the past eighty years, and whose design is particularly appropriate for a seaside parish.

The choir stalls are of oak, and a screen of wrought ironwork surmounted by a brass rail sets them apart from the central worship area. Behind those on the left is the Wyvern organ. Beyond them, marble steps lead to the High Altar, which is made of alabaster and was brought to Porthleven from the Church of St Peter and St Paul, Teddington, in the 1970s. The reredos is of painted stone, with three arched niches; in the central one is a figure of Christ the Eternal Priest, on the right a figure of St Elvan and to the left one of St Bartholomew.

The East Window commemorates the untiring work of Rev. T.L. Williams among the sick of the parish during the epidemic of diphtheria that spread through Porthleven in 1884. His own daughter was among those who died, and the processional cross used regularly here in worship was given by him in memory of her. Those attending Mass on any Sunday will see another item of historical interest in regular use. This is a fine silver thurible, given to the Church in memory of a lady who had been lady-in-waiting to Princess Marie-Louise, a granddaughter of Queen Victoria.

A rounded arch separates the Sanctuary from the Chancel, and from the ceiling hang seven lamps of polished brass and red glass. These oriental-style lamps came from Jerusalem, and represent the "seven lamps of fire burning before the Throne of God, which are the seven Spirits of God." (Revelations 4.5) To the left of the arch is the Church banner, bearing the emblem of St Bartholomew — three knives, the

instruments of his martyrdom when he was flayed alive.

Moving on to the left we see the pulpit, which is on a rounded base of painted stone and has a wrought ironwork surround which matches the adjacent chancel screen.

There is triple arcading of granite between the Church and the Lady Chapel, which is rectangular with a panelled apse. At the rear of the Chapel, (the western end), is an oak pew with carvings representing local fishing and farming interests on its frontal, and commemorative slate tablets on the wall behind it remind us that this Lady Chapel was given by Captain and Mrs. J.L. Rogers of Penrose as a memorial to their parents.

There are three windows on the north side. In the centre stands a figure of St Joseph, while on an adjacent sill, somewhat unexpectedly, an ornamental plate with views of Leeds is displayed. This is because groups of children from that city have for a number of years come to the parish on holiday, being entertained in the homes of members of the congregation.

This is a simply furnished chapel, with an atmosphere of tranquillity. The rounded apse at the eastern end has a pale blue ceiling which gives it an air of spaciousness, particularly when illuminated. Beneath it is an altar with plain wooden furnishings, in contrast to those of gleaming brass on the High Altar. Oil paintings in gilded frames from Penrose House and figures of the Virgin and Child provide colour and an indefinable feeling of warmth. There is a carved chair and lectern, and a wrought iron votive stand. As in the main church area, wooden chairs provide the seating.

Leaving the Lady Chapel, we move back around the Church, where we can view the fourteen hand-painted Stations of the Cross — five on the north side, four on the west and five on the south. These are of Flemish design, and feature the events of Our Lord's last walk from Pilate's Judgment Hall to Calvary. In the weeks prior to Good Friday they are the focus for prayerful meditation on the story of His Crucifixion.

Passing the last Station we are again near the Chancel. On the right is the door of the Choir Vestry and Kitchen area. From this there is a passageway leading to the Priest's Vestry and to a flight of stairs up to St Elvan's Room which was built in 1995 and is used for various meetings and by the Sunday School during part of Sunday Morning Mass.

Looking across to the north wall we have a good view of two fine memorial windows in stained glass, dated 1884 and 1904. As we move across to the centre aisle again, on our left is the brass lectern, now over a hundred years old, which is used each Sunday for the Ministry of the Word and Intercessions. Before leaving the Church, we should also notice the two striking stained glass windows high on the west wall, depicting St Barnabas and St Bartholomew and emphasising the apostolic tradition of our faith.

The modern additions of electric wall-mounted heaters, lighting and sound system are valued practical assets which manage to blend in successfully with the building's historic features.

We leave the Church having seen evidence of Christian witness and service since the consecration on 3rd August 1842.

# Harbour music: New location for Porthleven Band concerts meets with approval



● Framed by the picturesque setting of the harbour, members of Porthleven Town Band prepare for another open-air concert. Picture - Colin Ross

THERE has been much praise for Porthleven Town Band which reorganised its concerts this year to play in a new location on the front quay of the Harbour Hotel.

Visitors to the quayside concerts held this summer and local supporters were delighted with the new

venue. Michael Crowle, press secretary, said the landlord of the Harbour Hotel, David Morton, was now hoping to get sponsorship from St Austell Brewery for new band uniforms.

He said new bandmaster Francis Evans was bringing the band to competitive standards and next summer

will be competing in competitions throughout the south west.

Great enthusiasm is shown by all the younger members and there are now 14 in musical practice and six youth players are full members of the band.

A cross-section of ages are now rep-

resentative in the band with the youngest member, Tom Bassett, aged 12, who plays the big drum, following in the footsteps of his father Neil, who plays the fugle horn.

The eldest member is Lionel Williams, who plays bass.

Dennis Christophers can boast of

three generations of his family playing in the band including his son, Clive, daughter-in-law Cynthia and three grandchildren.

The band will be playing concerts regularly over the winter period with five nights of Christmas carols around the village.

SEPTEMBER

# Flying the flag: New site sought to commemorate special occasions



PORTHLEVEN Town Council is explore locations for a new flag staff which could fly the town flag on appropriate occasions.

The decision came following a suggestion by councillor Jim Stokes that the flag-staff at the war memorial should be used more than it is at the moment.

"We are a harbour and port and the town council has no flag-staff as such," said Mr Stokes, who has been responsible for the past two years for hoisting the flag.

He proposed the extended use of the flag-staff beside the war memorial to fly the Union Jack or an appropriate flag in recognition of national and commonwealth days and to celebrate local events such as Lifeboat Day and St Peterstide.

Michael Crowle said this would require a considerable stock of flags - where would they be kept and who would be responsible for them?

Kathleen Williams said: "I don't think the flag-staff at the war memorial should be used except on memorial days in honour of the men who died in the war."

John Strike recommended that the town council made an effort to find a suitable site for a new flag-staff in the town. Mr Stokes said he was prepared to draw up a list of suitable occasions for hoisting a flag to be agreed upon by members of the town council.

● Jim Stokes is pictured with the flag at Porthleven's war memorial. Picture - Colin Ross



The flag  
 handed  
 end of  
 too w  
 it was  
 a diff  
 on the  
 Alan Jo  
 I also



## TRURO CATHEDRAL FLOWER FESTIVAL

### "CELEBRATING CORNWALL 2000"

Patron: Lady Mary Holborow, Lord Lieutenant of Cornwall  
Chairman: The Very Revd Michael Moxon, Dean of Truro

24 October 2000

Dear Mrs. Adams

I write on behalf of the Festival Committee and the Cathedral Community to thank you for all your help and support for our recent Flower Festival (Celebrating Cornwall 2000).

It was an outstanding success and from the many comments that I have received, enormously appreciated. It drew together so many people and demonstrated the tremendous skill, imagination and flair which constantly enriches our life here in the South West.

You will, I am sure, be delighted to learn that as a result of the Festival, £1500. has been sent both to the Joey Appeal and to the White Cross Mission.

Please forgive a typewritten note; it comes with gratitude and every good wish.

Yours sincerely,

Michael Moxon



● Exhibitor Virginia Perkins, from St Agnes.



● Main picture: An exhibit depicting an aspect of the Royal Cornwall Show. Inset: Diane Luck, from Truro. Pictures - Camera Craft



● Exhibitor Marion Keen, from Newquay.

## Tribute to Cornwall and to a great friend

"STUNNING" said one visitor to Truro Cathedral for the display of flower arrangements celebrating the millennium. The 120 or more exhibits, reflected all aspects of Cornish life. Among the saints along "Pilgrims' Way" which filled the centre aisle, St Neot even had bubbling water in his holy well.

"I have seen flower festivals in St Paul's Cathedral, Tewkesbury Abbey and St George's, Windsor," said the Dean, the Very Rev Michael Moxon, at the opening, "but I am really

bowed over by this one." Lady Mary Holborow, the Lord Lieutenant and patron of the festival said that flowers enhanced the beauty of the cathedral and was a wonderful way to celebrate the Millennium marking 2000 years since the birth of Christ.

The original design was evolved in 1998 by Glynnis Beard and the late Jacqui Law who died last year. In the programme, Glynnis Beard who headed the Artistic Design Committee writes: "This Festi-



val is a tribute to the beautiful county of Cornwall as well as an acknowledgement of a great friend and flower arranger, sadly missed."

"It has been a very happy association," said the Dean, "between the National Association of Flower Arrangement Societies and flower arrangers from parishes all over Cornwall and the Cathedral."

Marion Suddell = I took part in this festival  
defecting Flora Jay.



The Childrens Dance. with ribbon for the  
headresses. the blue ribbon at the bottom  
end. of the arrangement cannot be seen  
too well here. this was my effort. altho if  
it was left to me. I would have done it in  
a different way.  
On the right is the mid day dance. &  
Alan Jay partly seen. in the corner. which  
I also arranged.

**PAT ADAMS PRIVATE COLLECTION**  
**24 SCRAPBOOKS IN TOTAL**  
**FROM 1972 TO 2015**

# PORTHLEVEN MUSEUM

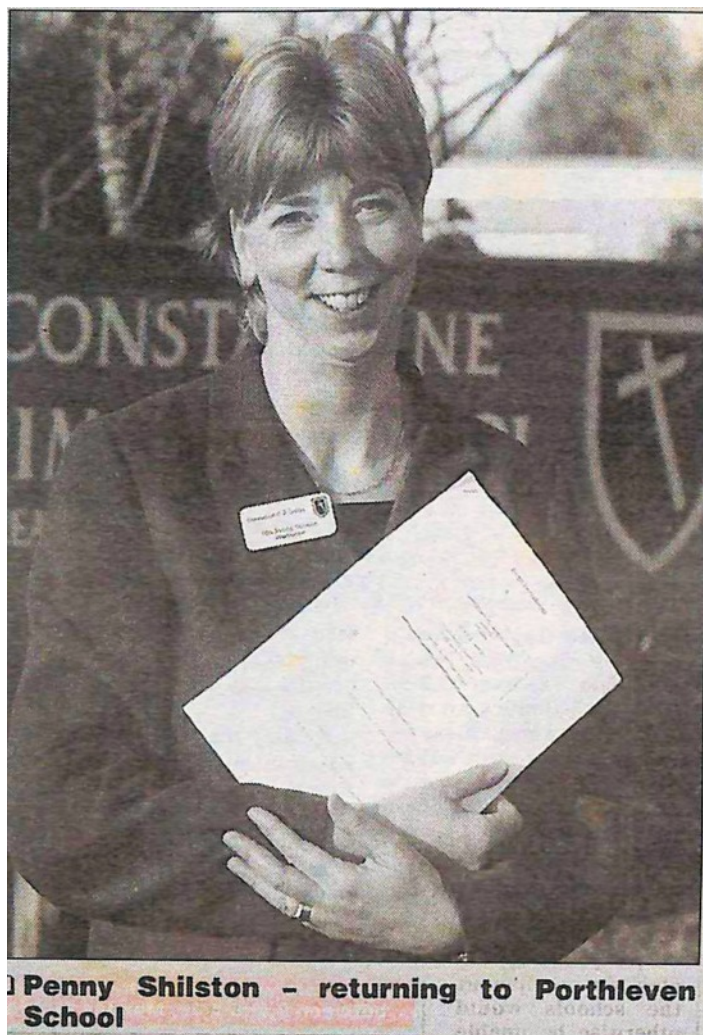
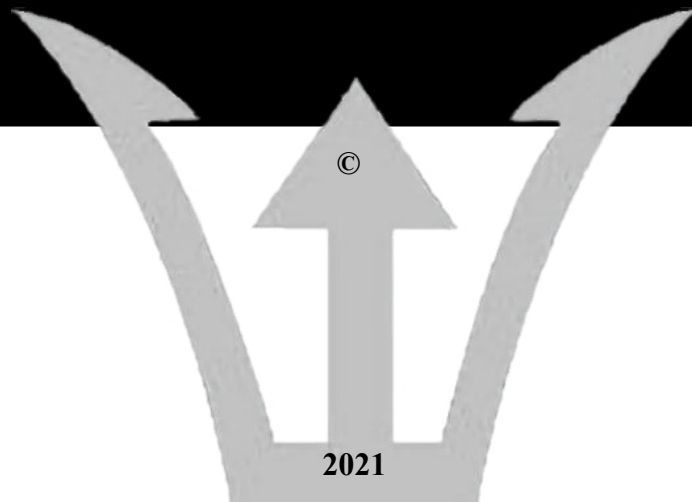

Penny Shilston - returning to Porthleven School

## PAT ADAMS SCRAP BOOK SERIES

### BOOK 16

FEBRUARY 2000 TO SEPTEMBER 2000

Category	Scrap Books	PLVCM2022.5.1
Category	Collection	PLVCM2022.7.1